

Mailer 2 - Individual Registration & Symposium Information
2025 ASCE Mid-America Student Symposium
Hosted by University of Nebraska-Lincoln & University of Nebraska-Omaha
April 3 – April 5, 2025



January 14, 2025

Dear ASCE Student Chapter of the ASCE Mid-America Student Conference:

This is your **2025 ASCE Mid-America Student Symposium** Mailer 2, the second of three informational packets to be sent to each of the participating ASCE Student Chapters in our Student Conference.

Please carefully read this information and forward copies to the appropriate members in your ASCE Student Chapter and team members for each team competing at the student symposium. Do not delete this mailer as information given within may not be repeated in subsequent mailers. Enclosed you will find the following information:

- ◆ Individual Registration & Mailer 2 Confirmation,
- ◆ Upcoming deadlines,
- ◆ Business Meeting,
- ◆ Tentative Symposium Schedule,
- ◆ Tentative Presentation Schedule,
- ◆ Society Competition Information,
- ◆ Local Competition Information,
- ◆ Student Symposium Paper Competition,
- ◆ ASCE Eligibility Requirements
- ◆ Hotel Information.

Receipt of this mailer should be confirmed by completing the Mailer 2 Acknowledgment Form by January 30, 2025.

Please note the individual registration deadline is February 13, 2025.

If you have any questions, feel free to contact us at our general student symposium e-mail address, listed below. All symposium information such as events, mailers, policies, rules, etc. will be posted on our website and is also listed below.

We look forward to your participation in the 2025 ASCE Mid-America Student Symposium and providing an opportunity to engage with other student chapters and ASCE Region Leadership.

Sincerely,

Mia Toigo
Chair, 2025 ASCE Mid-America Student Symposium
University of Nebraska-Lincoln

Anna Schuppel
Chair, 2025 ASCE Mid-America Student Symposium
University of Nebraska-Lincoln

ASCE Student Symposium website	https://studentsymposium.asce.org/mid-america/
General symposium email address	nebraskasympoium.2025@outlook.com
Symposium GroupMe	https://groupme.com/join_group/104892582/y6bAagd5

Individual Registration Form & Payment

STEP 1 - Mailer 2 Receipt Confirmation - *required*

Follow the link below to complete the Mailer 2 Receipt Confirmation due no later than January 30, 2025.

Mailer 2 Receipt Confirmation Link – <https://forms.office.com/r/dRg1S4U5sf>

STEP 2 - Individual Registration Form - *required*

[Individual Registration Form](#) is due before February 13, 2025.

Please visit our symposium website at [Individual Registration - Mid-America](#) to register for the 2025 ASCE Mid-America Student Symposium.

The [Individual Registration Form](#) must be filled out by *ALL individuals* attending the symposium including chapter members, team competitors, chapter spectators, guest teams, faculty advisors, volunteers, judges, and ASCE Region Leadership. The [Individual Registration Form](#) contains liability waiver information required by ASCE that must be reviewed and acknowledged by every individual attending, participating, and/or spectating at the symposium.

STEP 3 - Individual Registration Payment - *required*

Individual Registration is \$35 per person. Registration form and payment are due by February 13, 2025. After this date, the cost of individual registration increases to \$50 per person.

For individuals paying by credit card, go to: <https://marketplace.unl.edu/default/coe-asce-mid-america-student-symposium-2025.html>.

For individuals paying by check, make check payable to **University of Nebraska-Lincoln**

Attn: Candance Barnes
844 N 16th St
C190 Scott Engineering Center
Lincoln, NE 68588-0531

If your chapter is not participating in the 2025 ASCE Mid-America Student Symposium, please email nebraskasyposium.2025@outlook.com.

If your chapter will NOT be participating in the 2025 ASCE Mid-America Student Symposium, please email nebraskasyposium.2025@outlook.com.

Important Upcoming Deadlines

We highly recommend that you share this information with your chapter, including any competition captains.

2025 DEADLINES

<p>ASCE is still accepting Statement of Intent Forms for Society Competitions!</p>	<p>Statement of Intent & Acknowledgement of Eligibility Requirements Form due from each team intending to compete in a Society-wide or Society Pilot Competition – Concrete Canoe, Student Steel Bridge, Sustainable Solutions, Surveying, and 3D Printing.</p> <p><i>One form is required for each competition and must be filled out by the team captain and faculty advisor. <u>The online form* must be completed by the team captain and faculty advisor(s). Each entity will submit a separate form.</u></i></p> <p><i>* Concrete Canoe forms can be found in the 2025 ASCE Concrete Canoe Request for Proposal Rules. Concrete Canoe forms submitted after November 1, 2024, at 5:00 pm Eastern will be considered late submissions and subject to deduction.</i></p> <p><u>There is still time to complete a Statement of Intent Form to compete in an ASCE Society Competition!</u></p> <p>Statement of Intent to compete for Steel Bridge, Surveying, Sustainable Solutions <i>(must be completed by the team captain & the faculty advisor separately)</i></p> <p>Statement of Intent to compete for Construction Institute, Timber-Strong & 3D Printing <i>(must be completed by the team captain & the faculty advisor separately)</i></p>
<p>January 6, prior to 5:00 pm Eastern</p>	<p>The Surveying Competition Topographic Mapping Project was released to teams prior to 5:00 pm EST on the ASCE UESI Surveying Competition Collaborate Site.</p>
<p>January 13</p>	<p>Mailer 2 sent to each student chapter.</p>
<p>January 30</p>	<p>Mailer 2 Receipt Confirmation due from each student chapter.</p>
<p>February 1</p>	<p>ASCE Student Chapter Annual Reports are due by 11:59 pm Eastern Standard Time to ASCE. (More information on the Annual Reports can be found here. If you have questions on your Annual Report, email student@asce.org). <i>Submitting the ASCE Student Chapter Annual Report is an eligibility requirement to compete at the Student Symposia Competitions and to advance to Society-wide Competition Finals. See the eligibility requirements for details.</i></p>
<p>February 1</p>	<p>ASCE Student Chapter annual dues must be paid, as received by ASCE, no later than 11:59 p.m. Eastern Standard Time. <i>Paying ASCE Student Chapter annual dues is an eligibility requirement to compete at the Student Symposia Competitions and to advance to Society-wide Competition Finals. See the eligibility requirements for details.</i></p>

February 13 (postmarked by)	Attendee Registration is due.
February 13	Concrete Canoe Competition Project Proposal, Mix Design Sheets, & Materials Notebook due. (Upload to respective folder link provided by ASCE)
February 13	Concrete Cornhole Mix Design Spreadsheet Due (Email to nebraskasyposium.2025@outlook.com ; the subject line must include "University Name – Concrete Cornhole Competition Mix Design")
February 13	Concrete Bowling Mix Design Spreadsheet Due (Email to nebraskasyposium.2025@outlook.com ; the subject line must include "University Name – Bowling Competition Mix Design")
February 15	Hotel Reservations Cut-off
February 24	Surveying Competition Topographic Mapping Project Plans due by 5:00 pm EST (Unique and secure link to be provided to each team from ASCE)
March 1	Student Symposium Paper Competition submission due to nebraskasyposium.2025@outlook.com .
March 1	Sustainable Solutions Competition Technical Design Proposal, Envision Checklist and Criteria Justification, Public Outreach Poster, and Sketchup files are due. (Unique and secure link to be provided to each team from ASCE)
March 3	Mailer 3 (final) sent to each student chapter.
March 20	Mailer III Receipt Confirmation due from each student chapter.
March 20	Final Date for Late Registrations (with no guarantee of T-shirt/Swag).
April 3 – 5	2025 ASCE Mid-America Student Symposium

Business Meeting ([Eligibility Requirement](#))

The Business Meeting is tentatively scheduled to take place on Thursday, April 3, 2025 at 4:00 pm. Watch for the draft business meeting agenda that will be distributed via email to student chapters for review before the symposium.

The business meeting is the annual meeting for the Student Conference Board of Delegates. The Board of Delegates consists of two student delegates (*preferably a senior or junior in an ASCE leadership position and a sophomore in or aspiring to an ASCE leadership position*) and the faculty advisor from each student chapter.

The draft agenda will include unresolved discussion topics from the 2024 Business Meeting, the future host rotation, new business, the discussion and finalization of the Conference Policy and Procedures document, and other topics specific to the ASCE Mid-America Student Conference Region.

Each student delegate must be a member in good standing with their student chapter and ASCE. Each student chapter in the Student Conference has one vote. **At least one member of your ASCE student chapter must participate in the Business Meeting as part of the eligibility requirements to advance to finals for Concrete Canoe, Steel Bridge, Sustainable Solutions, and Surveying.**

[Click here for ASCE Eligibility Requirements](#)

Tentative Student Symposium Schedule

Drug and Alcohol-Free Events

The use of drugs and alcohol is prohibited at all ASCE Student Symposium events.

TIME	THURSDAY – UNL Campus			
12:00	Registration			
12:30				
1:00				
1:30				
2:00				
2:30				
3:00	Welcome Ceremony			
3:30				
4:00	Opening Speaker	Business Meeting		
4:30				
5:00	Dinner	Break		
5:30		FE Quiz Bowl Preliminary Round		
6:00		Concrete Cornhole	Concrete Bowling	Outdoor Social Event
6:30				
7:00	Captains Meeting - C.C., S.S., Mead Paper, 3D Printing, Surveying	FE Quiz Bowl Finals Round	1st & 2nd Year Mystery Design Challenge	
7:30				
8:00				
8:30				
9:00				
9:30				
10:00				

TIME	FRIDAY – Holmes Lake					
7:00	Concrete Canoe Competition					
7:30						
8:00		Surveying Task I				
8:30						
9:00		Surveying Task II				
9:30						
10:00		Surveying Task III				
10:30						
11:00		Surveying Task III				
11:30						
12:00		Lunch				
12:30						
1:00		Surveying Task IV				
1:30						
2:00						
2:30						
3:00						
3:30						
4:00	Break					
4:30	Break					
FRIDAY – UNL Campus						
5:00	Captains Meeting - Steel Bridge		Sustainable Solutions Posters - Session 1, Surveying Plan Set Display	Concrete Bowling Strength Testing		
5:30						
6:00	Concrete Canoe Presentations	Mead Paper Presentations	Transportation Competition, Surveying Topo Mapping Presentation	Pop-Up Leadership Workshop 1	3D Printed Bridge Competition	
6:30						
7:00						
7:30						
8:00						
8:30						
9:00						
9:30						
10:00						

TIME	SATURDAY – UNL Campus		
7:00	Steel Bridge Competition		
7:30		Sustainable Solutions Posters - Session 2	
8:00			
8:30			
9:00			
9:30		Sustainable Solutions Presentations	
10:00			
10:30			
11:00			Pop-Up Leadership Workshop 2
11:30			
12:00		Lunch	
12:30			
1:00			Pop-Up Leadership Workshop 3
1:30			
2:00			
2:30			
3:00			
3:30			
4:00	Break		
4:30			
5:00	Career Fair		
5:30			
6:00	Banquet		
6:30			
7:00			
7:30			
8:00			
8:30			
9:00			
9:30			
10:00			

Tentative Presentation Schedules

Student Symposium Paper Presentations Date: Friday, April 4	
<u>School</u>	<u>Timeslot</u>
<u>University of Missouri-Kansas City</u>	<u>6:00 PM</u>
<u>William Jewell College</u>	<u>6:10 PM</u>
<u>Missouri University of Science & Technology</u>	<u>6:20 PM</u>
<u>University of Nebraska-Lincoln at Omaha</u>	<u>6:30 PM</u>
<u>Kansas State University</u>	<u>6:50 PM</u>
<u>Iowa State University</u>	<u>7:00 PM</u>
<u>Dordt University</u>	<u>7:10 PM</u>
<u>University of Kansas</u>	<u>7:20 PM</u>
<u>Benedictine College</u>	<u>7:40 PM</u>
<u>Saint Louis University</u>	<u>7:50 PM</u>
<u>University of Nebraska-Lincoln</u>	<u>8:00 PM</u>
<u>Southern Illinois University Carbondale</u>	<u>8:10 PM</u>
<u>Missouri State University</u>	<u>8:30 PM</u>
<u>Southern Illinois University Edwardsville</u>	<u>8:40 PM</u>
<u>University of Iowa</u>	<u>8:50 PM</u>
<u>University of Missouri-Columbia</u>	<u>9:00 PM</u>
<u>South Dakota State University</u>	<u>9:10 PM</u>

Sustainable Solutions Presentations
Date: Saturday, April 5

<u>School</u>	<u>Timeslot</u>
<u>Missouri University of Science & Technology</u>	<u>9:45 AM</u>
<u>University of Nebraska-Lincoln</u>	<u>10:05 AM</u>
<u>Missouri State University</u>	<u>10:25 AM</u>
<u>Kansas State University</u>	<u>10:45 AM</u>
<u>Saint Louis University</u>	<u>11:05 AM</u>
<u>University of Iowa</u>	<u>11:25 AM</u>
<u>University of Missouri-Columbia</u>	<u>11:45 PM</u>

Concrete Canoe Presentations Date: Friday, April 4	
<u>School</u>	<u>Timeslot</u>
<u>University of Iowa</u>	<u>6:00 PM</u>
<u>Kansas State University</u>	<u>6:15 PM</u>
<u>South Dakota State University</u>	<u>6:30 PM</u>
<u>Missouri University of Science & Technology</u>	<u>6:45 PM</u>
<u>Iowa State University</u>	<u>7:15 PM</u>
<u>Dordt University</u>	<u>7:30 PM</u>
<u>University of Missouri-Columbia</u>	<u>7:45 PM</u>
<u>University of Kansas</u>	<u>8:00 PM</u>
<u>University of Missouri-Kansas City</u>	<u>8:15 PM</u>
<u>University of Nebraska-Lincoln</u>	<u>8:45 PM</u>
<u>Southern Illinois University Carbondale</u>	<u>9:00 PM</u>
<u>Benedictine College</u>	<u>9:15PM</u>
<u>University of Nebraska-Lincoln at Omaha</u>	<u>9:30 PM</u>
<u>Southern Illinois University Edwardsville</u>	<u>9:45 PM</u>

Surveying Presentations Date: Friday, April 4	
<u>School</u>	<u>Timeslot</u>
<u>Southern Illinois University Carbondale</u>	<u>7:00 PM</u>
<u>Missouri State University</u>	<u>7:20 PM</u>
<u>Kansas State University</u>	<u>7:40 PM</u>
<u>University of Nebraska-Lincoln</u>	<u>8:20 PM</u>
<u>Saint Louis University</u>	<u>8:40 PM</u>
<u>University of Iowa</u>	<u>9:00 PM</u>

Tentative Presentation Schedules continued....

3D Printing Presentations Date: Friday, April 4	
<u>School</u>	<u>Timeslot</u>
<u>Missouri State University</u>	<u>5:30 PM</u>
<u>Benedictine College</u>	<u>6:05 PM</u>
<u>William Jewell College</u>	<u>6:40 PM</u>
<u>University of Nebraska-Lincoln</u>	<u>7:15 PM</u>
<u>University of Iowa</u>	<u>8:00 PM</u>
<u>Kansas State University</u>	<u>8:35 PM</u>
<u>Saint Louis University</u>	<u>9:10 PM</u>

Society Competition Information

SOCIETY COMPETITIONS AT THE 2025 ASCE MID-AMERICA STUDENT SYMPOSIUM

Society-wide Competitions

ASCE Sustainable Solutions Competition



ASCE UESI Surveying Competition



AISC/ASCE Student Steel Bridge Competition



ASCE Concrete Canoe Competition



Society Pilot Competitions

ASCE 3D Printing Competition

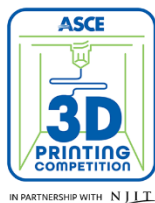

Society competition rules can be found at:

<https://www.asce.org/communities/student-members/conferences/rules>

Local Competition Information

LOCAL COMPETITIONS AT THE 2025 ASCE MID-AMERICA STUDENT SYMPOSIUM

Student Symposium Paper Competition <i>Participation is a requirement for advancement to Society-wide competition finals and SSBC National Finals</i>	Concrete Bowling Competition	Concrete Cornhole Competition	FE Quiz Bowl Competition
Transportation Competition	1st & 2nd Year Mystery Design Challenge		

Competition rules can be found on our website at <https://studentsymposium.asce.org/mid-america/>.

Student Symposium Paper Competition

The ASCE Student Symposium Paper Competition emphasizes the importance of being able to write and present a paper as essential communication skills for all engineers and often necessary for advancement in your career. The competition consists of a paper submission and a presentation at the student symposium.

The topic for the 2025 ASCE Mid-America Student Symposium Paper Competition is: **Considering ethics, what role do civil engineers play in the prevention and response to an infrastructure disaster? Should an infrastructure disaster rouse civil engineers globally to advocate for more resilient protections for built infrastructure from climate-driven and/or man-made disasters?**

Consider the Francis Scott Key Bridge Collapse in Maryland, the Interstate 95 Collapse in Pennsylvania, or other infrastructure disasters. Civil engineers are responsible for planning, designing, constructing, maintaining, and operating infrastructure while protecting and advancing the health, safety, and welfare of the public. Following large infrastructure disasters, civil engineers are often placed in the public spotlight to respond and assess the cause of the disaster and how to prevent future similar events.

Submission deadline is: March 1, 2025

Submission email link is: nebraskasympsoium.2025@outlook.com

This topic is the same topic as the [Daniel W. Mead Prize for Students](#). However, the Student Symposium Paper Competition and the Daniel W. Mead Prize for Students are two separate competitions and **must be submitted separately**. The Student Symposium Paper Competition paper is due March 1 and submitted to nebraskasympsoium.2025@outlook.com. The [Daniel W. Mead Prize for Students](#) is due March 1st and submitted to student@asce.org.

*****SOCIETY-WIDE FINALS ELIGIBILITY REQUIREMENT*****

Both the paper submission and the presentation are mandatory for any ASCE Student Chapter participating in the 2025 ASCE Mid-America Student Symposium that wishes to be eligible to advance to ASCE Society-wide competition finals and SSBC National Finals. Competitions **requiring** participation include:

- ◆ ASCE Concrete Canoe Competition
- ◆ ASCE Sustainable Solutions Competition
- ◆ ASCE UESI Surveying Competition, and
- ◆ AISC/ASCE Student Steel Bridge Competition.

Note: Any papers/presentations created for any other competition do not count as an entry into the Student Symposium Paper Competition.

ASCE Society Competition Eligibility Requirements

Competitions that advance to an ASCE Society-wide Competition Finals include the ASCE Concrete Canoe Competition, ASCE Sustainable Solutions Competition, and ASCE UESI Surveying Competition. The AISC/ASCE Student Steel Bridge Competition advances to the SSBC National Finals and follows the eligibility requirements below. See [SSBC Rules](#) for more information.

The purpose of student competitions is to provide student members career-enrichment opportunities to gain hands-on, practical experience and leadership skills. Society Competitions are an important and special opportunity to showcase the engineering and professional skills of student teams. As such, mutual respect is required for all stakeholders, including competitors, judges, hosts, and guests. Invitations to the Student Symposia and the ASCE Student Civil Engineering Championships/Society-wide Competition Finals are a privilege, not a right. Failure to act professionally can result in sanctions, disqualifications, and loss of invitations. Please note that the requirements for eligibility for Society-wide competition finals are more stringent than the requirements for participation at the student symposia competitions.

ELIGIBILITY FOR STUDENT SYMPOSIUM COMPETITION

The following qualifications are required of all ASCE Student Chapters to compete at the Student Symposia Competitions:

An ASCE Student Chapter must:

1. Be in good standing with ASCE:
 - a. Have paid their annual dues, as received by ASCE, **no later than the start of their Student Symposium.**
 - b. Have submitted their student chapter's full Annual Report or EZ Annual Reporting Form **no later than February 1, 11:59 p.m. EST.**

ELIGIBILITY FOR ASCE SOCIETY-WIDE COMPETITION FINALS

The following qualifications are required of all ASCE Student Chapters in order to advance to the ASCE Society-wide Competition Finals:

An ASCE Student Chapter must:

1. Be in good standing with ASCE:
 - a. Have paid their annual dues, as received by ASCE, no later than February 1, 11:59 p.m. EST.
 - b. Have submitted their student chapter's **full Annual Report, no later than February 1, 11:59 p.m. EST, and have received a minimum score of 25 points out of a possible 100. Student Chapters that submit an EZ annual reporting form do not qualify** to advance to competition finals; and
2. Attend and participate in their assigned Student Symposium as shown through their school's:
 - a. On-time attendance and active participation by a member of the ASCE Student Chapter at the Student Symposium Business Meeting.
 - b. Participation in the Student Symposium Paper Competition, including submission and presentation by a member of the ASCE Student Chapter. Note that any papers/presentations created for any other competition do not count as an entry into the Student Symposium Paper Competition.

Questions regarding eligibility should be directed to student@asce.org.

SSBC Local Spatial Restriction Information

This year's AISC/ASCE Student Steel Bridge Competition will be held in the basement of Kiewit Hall on the University of Nebraska-Lincoln - City Campus. Due to the dimensions of the space, the dimensions of the transportation zone have been modified. The diagrams shown below lay out the specific local conditions that will be present in this year's Mid-America competition. The Kiewit Hall Lower Level Floor Plan has been updated for Mailer 2 to reflect the maximum single object usable space in the freight elevator (5' x 8'). If additional space will be required for teams to move materials between ground level and lower level, please contact the host as soon as feasible to work out alternative arrangements.

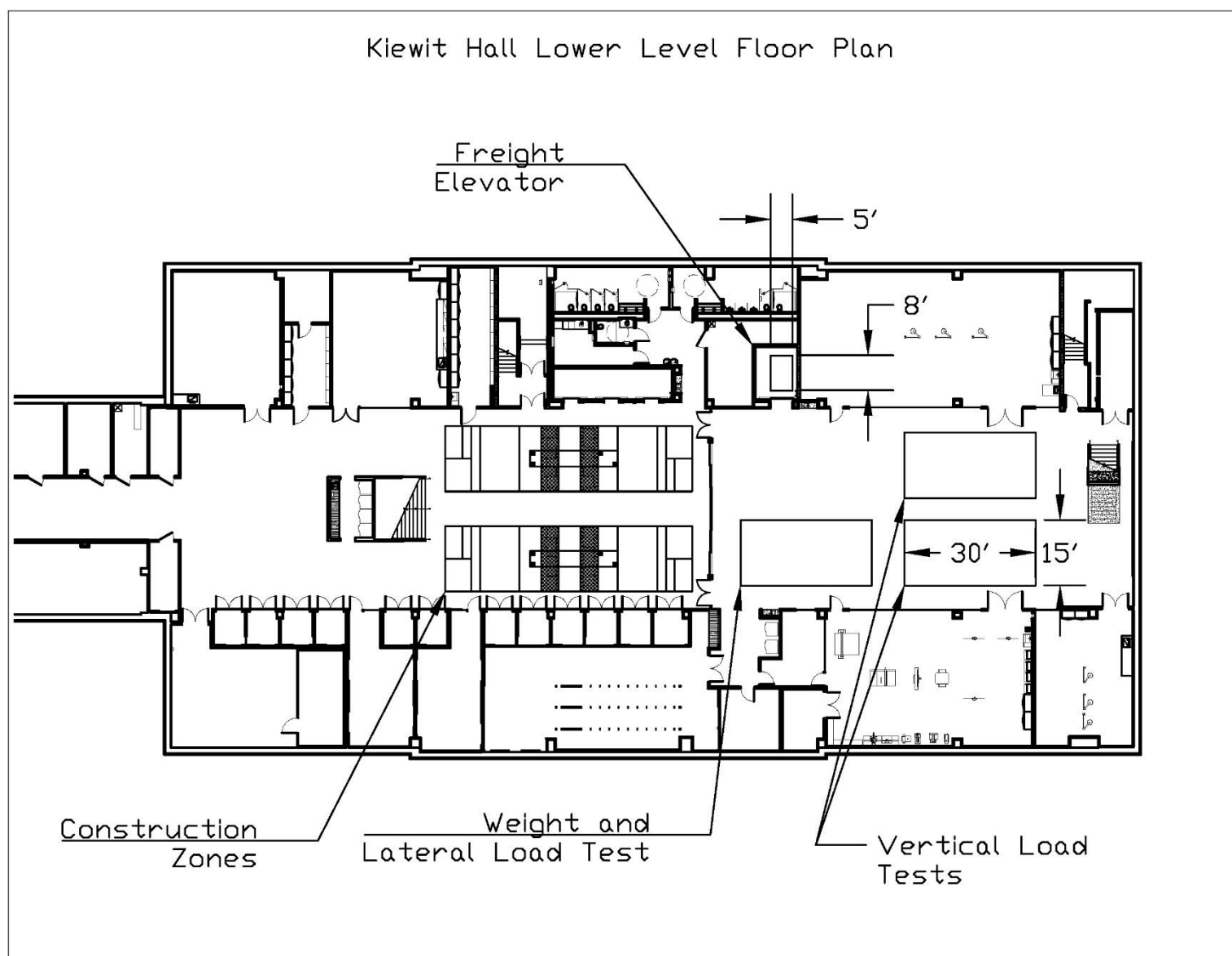

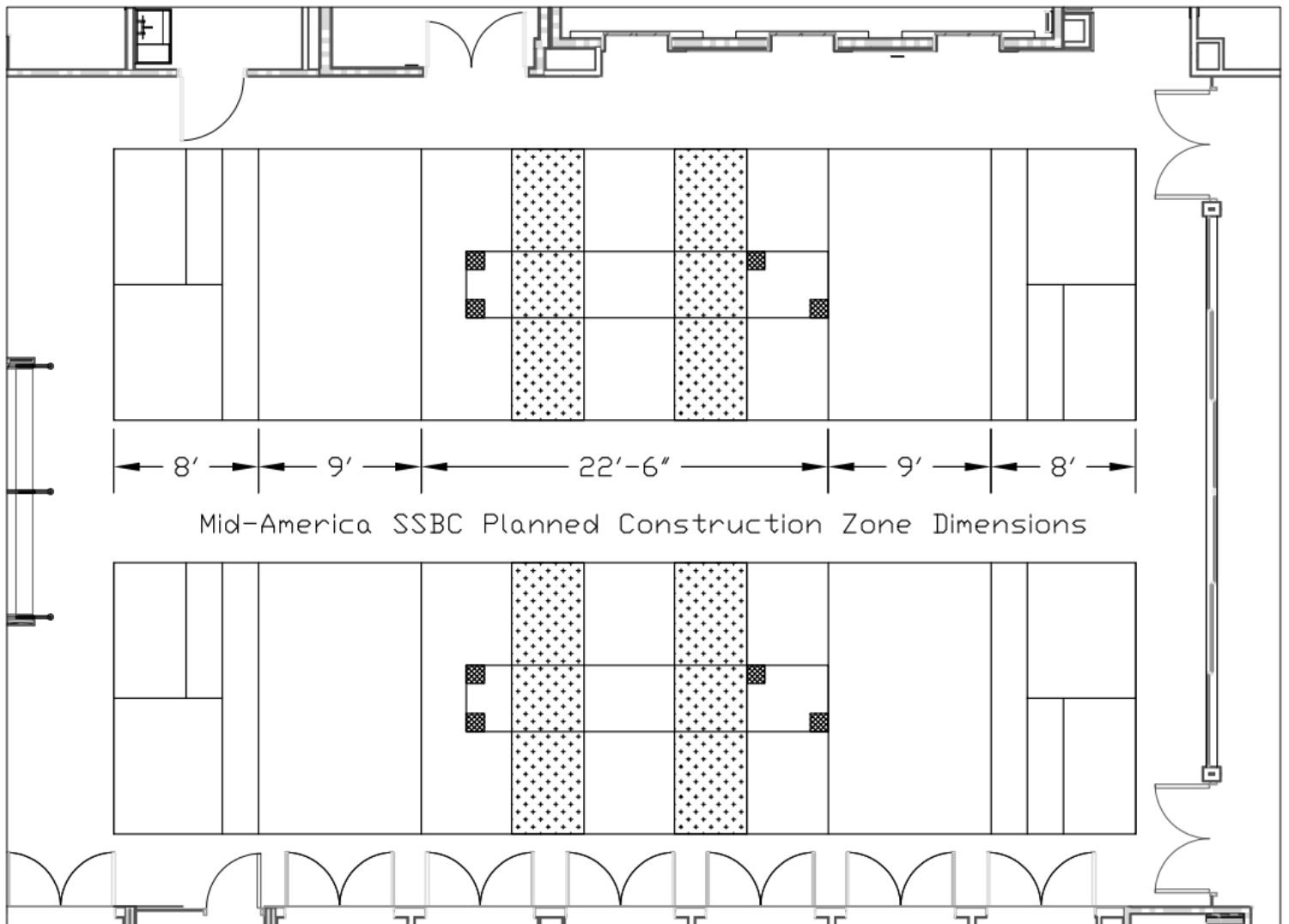

Mid-America SSBC Planned Construction Zone Dimensions

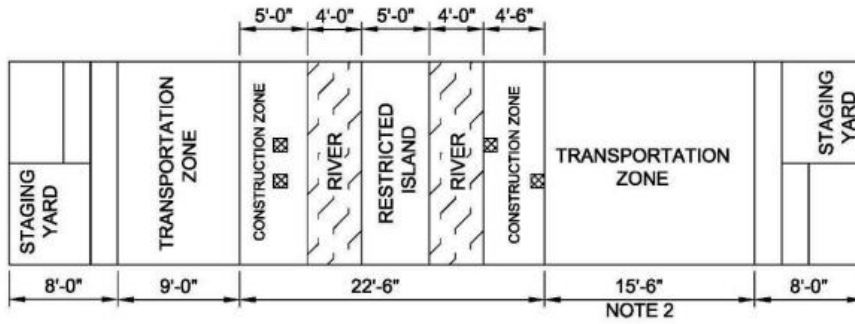

CONSTRUCTION SITE PLAN

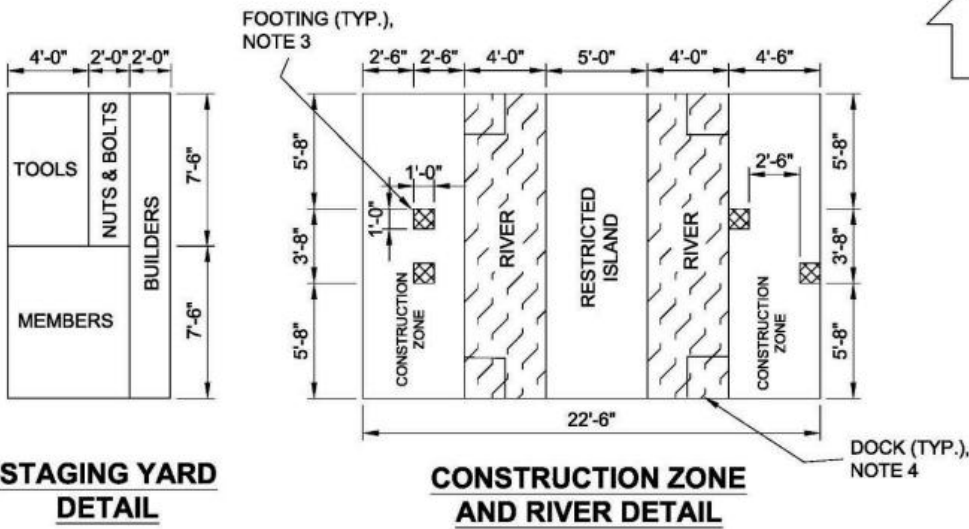

STUDENT
 STEEL BRIDGE
 COMPETITION
 2025



NO.	DATE	DESCRIPTION
PROJECT NO:	2025	DRAWN BY: JPM
DATE:	8/29/2024	CHECKED BY: SSBC RC
DRAWING TITLE:		
SITE PLAN		
DRAWING NUMBER:		
DWG 1		

- 1 SITE PLAN**
- NOTES:
 1. DRAWINGS ARE NOT TO SCALE
 2. DIMENSION MAY BE REDUCED TO FIT LOCAL CONDITIONS.
 3. ALL FOUR FOOTINGS ARE 1' BY 1'.
 4. ALL DOCK AREAS ARE 2' BY 2'.

Hotel Information

Multiple hotel blocks with discounted rates have been reserved for ASCE student chapters for the entire duration for the symposium including the nights of April 3-5th. Space at each location is limited; we recommend you make reservations as soon as possible and do not wait until the deadline of **February 15**. If you have any issues or concerns, please email Annie Meyers at amyers27@unl.edu.

Hilton Garden Inn Lincoln Downtown/Haymarket

- Address: 801 R St, Lincoln, NE, 68508
- Reservation Link: [Hilton Garden Inn Hotel Block](#)
- ASCE Symposium Rates: \$125 per night (includes breakfast, Wi-Fi, and pool; parking \$19 per vehicle per day)

Courtyard by Marriott Lincoln Downtown/Haymarket

- ◆ Address: 808 R St, Lincoln, NE, 68508
- ◆ Reservation Link: [Courtyard by Marriott Hotel Block](#)
- ◆ ASCE Symposium Rates: \$132 per night (includes Wi-Fi and fitness center; parking \$11.25 daily max in garage next door)

The Graduate by Hilton Lincoln

- ◆ Address: 414 N 9th St, Lincoln, NE, 68508
- ◆ Reservation Link: [The Graduate Hotel Block](#)
- ◆ ASCE Symposium Rates: \$149 per night (includes Wi-Fi, pool, fitness center, and parking suggested for small vehicles only; vans and trucks more suitable to park at “Haymarket Garage” for \$11.25 daily max)

Holiday Inn & Suites – Downtown

- ◆ Address: 905 O Street Lincoln, Nebraska 68508
- ◆ Reservation Link: [Holiday Inn & Suites - Downtown](#)
- ◆ Must enter the dates first, and then the room booking will pull up.
- ◆ ASCE Symposium Rates: \$100 per night, 49-K (includes breakfast, Wi-Fi, pool, fitness center, and parking for \$10/day/car or van or \$20/day/bus)

Tru by Hilton Lincoln East

- ◆ Address: 305 N 50th St, Lincoln, NE 68504
- ◆ Reservation Link: [Tru by Hilton Hotel Block](#)
- ◆ ASCE Symposium Rates: \$163 per night (includes breakfast, Wi-Fi, pool, fitness center, and parking)

Comfort Suites Lincoln East – Mall Area

- ◆ Address: 331 N Cotner, Lincoln, NE 68505
- ◆ Reservation Link: [Comfort Suites Hotel Block](#)
- ◆ ASCE Symposium Rates: \$120 per night, 10-QQ Suite (includes breakfast, Wi-Fi, pool, fitness center, and parking)

Hampton Inn & Suites I-80

- ◆ Address: 7343 Husker Circle, Lincoln, NE 68504
- ◆ Reservation Link: [Hampton Inn & Suites I-80 Block](#)
- ◆ ASCE Symposium Rates: \$119 per night, 15-QQ and 15-K Suite (includes breakfast, Wi-Fi, pool, fitness center, and parking)

Country Inn & Suites

- ◆ Address: 5353 N 27th St, Lincoln, NE 68521
- ◆ Reservation Link: [Country Inn & Suites Hotel Block](#)
- ◆ ASCE Symposium Rates: \$144 Thursday, \$124 per night Friday and Saturday, 20-QQ and 5-K (includes breakfast, Wi-Fi, pool, fitness center, and parking)

Hampton Inn Lincoln South – Heritage Park

- ◆ Address: 5922 Vandervoort Drive, Lincoln, NE 68516
- ◆ Reservation Link: [Hampton Inn Lincoln South Hotel Block](#)
- ◆ ASCE Symposium Rates: \$159 per night, 15-QQ and 5-K (includes breakfast, Wi-Fi, pool, fitness center, and parking)