



PSWS

HAWAII'1 2024

Mailer 2

Student Registration and
Symposium Information

April 3, 2024 - April 6, 2024



2024 ASCE Pacific Southwest Student Symposium
University of Hawai'i at Mānoa
April 3, 2024 - April 6, 2024

January 20, 2024,

Dear ASCE Student Chapter of the Pacific Southwest Student Conference:

This is your **2024 ASCE Pacific Southwest Student Symposium Mailer II**, the second of three informational packets to be sent to each of the participating ASCE Student Chapters in our Student Conference. In addition, you can find information on the schedule, competitions, hotel bookings, registration, and location addresses on our [student symposium website](#).

Please carefully read through this packet and forward copies to the appropriate members in your Student Chapter (team captains, individual team members, etc.). Do not delete this mailer as information given within may not be repeated in subsequent mailers. Enclosed you will find the following information:

- Receipt confirmation,
- Individual registration information,
- Upcoming deadlines,
- Tentative student symposium schedule,
- Competition resource table and link to rules,
- ASCE competition eligibility requirements,
- Student Symposium Paper Competition information,
- Business Meeting information,
- ASCE Pop-up Leadership Workshops information, and
- Hotel information.

Receipt of this mailer should be confirmed by January 30, 2024. Please note the individual registration deadline is February 17, 2024.

If you have any questions, feel free to contact us at the e-mail address: psws2024.hawaii@gmail.com

We look forward to your participation in the [2024 ASCE Pacific Southwest Student Symposium](#) and providing an opportunity to engage with other student chapters and ASCE Region Leadership.

Sincerely,

Travis Nitta

Chair, 2024 PSW Student Symposium
University of Hawai'i at Mānoa

Koby Kosaki

President, ASCE Student Chapter



ASCE Student Symposium Website: <https://studentsymposium.asce.org/pacificsouthwest/>



ASCE at UH Mānoa chapter Instagram: [asceuhm](#)



General symposium email address: psws2024.hawaii@gmail.com



RECEIPT CONFIRMATION

STEP 1 - MAILER 2 RECEIPT CONFIRMATION - required

Please fill out the following google form to confirm that you have received Mailer 2 for the 2024 PSW Student Symposium:

[Mailer 2 Confirmation Form](#)

STEP 2 - INDIVIDUAL REGISTRATION FORM - required

Individual Registration Form is due before February 17, 2024.

Please visit our symposium website at <https://studentsymposium.asce.org/pacificsouthwest/> to register for the 2024 ASCE PSW Student Symposium.

The Individual Registration Form must be filled out by ALL individuals attending the symposium including chapter members, team competitors, chapter spectators, guest teams, faculty advisors, volunteers, judges, and ASCE Region Leadership. The Individual Registration Form contains liability waiver information that must be reviewed and acknowledged by every individual attending, participating, and/or spectating at the symposium.

STEP 3 - INDIVIDUAL REGISTRATION PAYMENT - required

Individual Registration is \$180 per person. Registration form and payment are due by February 17, 2024.

Make check payable to ASCE Student Symposium

Attn: ASCE at UH Mānoa

2540 Dole Street, Holmes Hall 383

Honolulu, HI 96822

If your chapter is not participating in the 2024 ASCE PSW Student Symposium, please email psws2024.hawaii@gmail.com



UPCOMING DEADLINES

- ASAP Timber-Strong Design Build teams must all complete [the Ladder Training Safety](#) online course and submit certification of completion to Cerberus before project work begins. *(Unique and secure link to be provided to each team from ASCE)*
- Intent Forms are still being accepted for the following Society competitions: *Concrete Canoe (with deductions), Steel Bridge, Sustainable Solutions, Surveying, and Timber-Strong Design Build.*
- January 8, 2024 Surveying Competition Task 1A Mapping Project released to teams by 5:00pm EST in the [ASCE UESI Surveying Competition Collaborate Site](#)
- January 20th Mailer II sent to each student chapter
- January 26th Timber-Strong Design Build Phase One Project deliverables due. *(Unique and secure link to be provided to each team from ASCE)*
- January 30th Mailer II Receipt Confirmation due from each student chapter
- February 1st ASCE Student Chapter annual dues must be paid, as received by ASCE, no later than 11:59 p.m. EST. *Paying ASCE Student Chapter annual dues is an [eligibility requirement](#) to compete at the Student Symposia Competitions and to advance to Society-wide Competition Finals. See the [eligibility requirements](#) for details.*
- February 1st ASCE Student Chapter Annual Reports due by 11:59 pm EST to ASCE. *(More information on Annual Reports can be found [here](#). If you have questions on your Annual Report, email student@asce.org). Submitting the ASCE Student Chapter Annual Report is an [eligibility requirement](#) to compete at the Student Symposia Competitions and to advance to Society-wide Competition Finals. See the [eligibility requirements](#) for details.*
- February 16th Concrete Canoe Project Proposal, Mix Design Sheets, and Materials Notebook due *(Upload to respective folder link provided by ASCE)*
- February 17th Attendee Registration payment due (postmark date if mailing)



UPCOMING DEADLINES CONTINUED

- February 23rd** ● Timber-Strong Design Build Phase Two Project deliverables due. *(Teams to use the same unique link that was provided for Phase One Project deliverables)*
- February 26th** ● Surveying Competition Task 1A Projects due by 5:00pm EST *(Unique and secure link to be provided to each team from ASCE)*
- March 1st** ● Student Symposium Paper Competition Submission due to psws2024.hawaii@gmail.com
- March 1st** ● Mailer III (final) sent to each student chapter.
- March 1st** ● Timber-Strong Design Build Phase Three Project deliverables due. *(Teams to use the same unique link that was provided for Phase One Project deliverables)*
- March 1st** ● Final Date for Late Registrations
- March 1st** ● Hotel Reservations Cut-off - Outrigger
- March 13th** ● Sustainable Solutions Competition Technical Design Proposal, Envision Checklist and Criteria Justification, Public Outreach Poster, Sketchup files due *(Unique and secure link to be provided to each team from ASCE)*
- March 15th** ● Mailer III Receipt Confirmation due from each student chapter
- March 24th** ● Hotel Reservations Cut-off - Holiday Inn
- March 30th** ● Timber-Strong Design Build - All Change Orders and final submittals uploaded to ASCE's Cerberus ftp server *(Teams to use the same unique link that was provided for Phase One Project deliverables)*
- April 4-6, 2024** ● 2024 ASCE PSW Student Symposium

If your student chapter plans to compete in the Student Steel Bridge Competition, please complete the [Student Steel Bridge Competition – ASCE Student Chapter Participation Form](#) as soon as possible if you haven't already done so. Completing this form is necessary in order to receive your SSBC team stipend.



TENTATIVE SYMPOSIUM SCHEDULE

Wednesday, April 3rd 2024		
Event	Time	Location
Student Chapter Check-In	4:00 PM-7:00 PM	Holmes Hall

Thursday, April 4th 2024		
Event	Time	Location
Concrete Canoe Display Set-Up	6:00 AM-8:00 AM	McCarthy Mall
Steel Bridge Setup/Registration	8:00 AM-10:00 AM	McCarthy Mall
Sustainable Solutions Captains Meeting	8:00 AM-10:00 AM	Campus Center/Hemenway Hall
Geowall Presentation	8:00 AM-11:00 AM	Campus Center/Hemenway Hall
Prestressed Concrete Casting	8:00 AM-12:00 PM	Holmes Hall
Concrete Canoe Displays	8:00 AM-12:00 PM	McCarthy Mall
Technical Paper Presentation	8:00 AM-12:00 PM	Campus Center/Hemenway Hall
Surveying Presentations/Displays	8:00 AM-12:00 PM	Campus Center/Hemenway Hall
Transportation Poster Display	9:00 AM-11:00 AM	McCarthy Mall
Ulu Maika	9:00 AM-4:00 PM	Bachman Lawn
HukiHuki	9:00 AM-4:00 PM	Bachman Lawn
Moa Pahe'e	9:00 AM-4:00 PM	Bachman Lawn
Kan Jam	9:00 AM-4:00 PM	Bachman Lawn
Pop-Up Leadership Workshop	10:00 AM - 11:00 AM	Campus Center/Hemenway Hall
Timber-Strong Captains Meeting	10:00 AM-12:00 PM	Campus Center/Hemenway Hall
Sustainable Solutions Poster Display	10:00 AM-12:00 PM	McCarthy Mall
Steel Bridge Aesthetics Judging	10:00 AM-12:00 PM	McCarthy Mall
Career Fair	10:00 PM-2:00 PM	McCarthy Mall
Geowall Captains Meeting	11:00 AM-12:00 PM	Holmes Hall
Lunch	11:00 AM-1:00 PM	Campus Center/Hemenway Hall
Surveying Captains Meeting	12:00 PM-1:00 PM	Campus Center/Hemenway Hall
Concrete Canoe Presentations	12:00 PM-4:00 PM	Campus Center/Hemenway Hall
Transportation Presentation	12:00 PM-5:00 PM	Campus Center/Hemenway Hall
Pop-Up Leadership Workshop	12:30 PM - 1:30 PM	Campus Center/Hemenway Hall
Steel Bridge Captains Meeting	1:00 PM-3:00 PM	Campus Center/Hemenway Hall
Sustainable Solutions Presentations	1:00 PM-5:00 PM	Campus Center/Hemenway Hall
Steel Bridge Judge's Training	3:00 PM-5:00 PM	Holmes Hall
Concrete Canoe Captains Meeting	4:00 PM - 6:00 PM	Campus Center/Hemenway Hall
Scavenger Hunt	All Day	UH Mānoa Campus



TENTATIVE SYMPOSIUM SCHEDULE

Friday, April 5th 2024		
Event	Time	Location
Concrete Canoe Set Up and Swamp Test	7:00 AM-9:00 AM	Ke`ehi Lagoon
Surveying Competition	8:00 AM-4:00 PM	Ke`ehi Lagoon
Concrete Canoe Races	9:00 AM-4:00 PM	Ke`ehi Lagoon
Ultimate Frisbee	9:00 AM-4:00 PM	Ke`ehi Lagoon
Kickball	9:00 AM-4:00 PM	Ke`ehi Lagoon
Soccer	9:00 AM-4:00 PM	Ke`ehi Lagoon
Scavenger Hunt	9:00 AM-4:00 PM	Ke`ehi Lagoon
Geowall Competition	10:00 AM-3:00 PM	Ke`ehi Lagoon
Lunch	11:00 AM-1:00 PM	Ke`ehi Lagoon

Saturday, April 6th 2024		
Event	Time	Location
Steel Bridge	7:00 AM-3:00 PM	TBD
Timber-Strong Design Build	8:00 AM-2:00 PM	Holmes Hall
Environmental Competition	8:00 AM-3:00 PM	Holmes Hall
Prestressed Concrete Testing	8:00 AM-12:00 PM	Holmes Hall
Basketball	9:00 AM-4:00 PM	TBD
Volleyball	9:00 AM-4:00 PM	TBD
Dodgeball	9:00 AM-4:00 PM	TBD
Lunch	11:00 AM-1:00 PM	TBD
Environmental Presentations	12:00 PM-3:30 PM	Holmes Hall
Pop-Up Workshop	12:00 PM - 1:00 PM	Holmes Hall
Business Meeting	1:30 PM-3:30 PM	Holmes Hall
Scavenger Hunt	Due at 4:00 PM	UH Mānoa Campus
Awards Banquet	6:00 PM-11:00 PM	Hawai'i Convention Center





Student Chapter Resources Needed for Society Competition and Events

Please visit [ASCE Society-wide Competition Rules & Regulations](#) to view the "[Student Chapter Resources Needed for Society Competitions and Events](#)" table. This resource table outlines student chapter resources and time needed to compete in each of the Society-wide competitions, pilot competitions, and events. (Note that this is guidance and estimates. Student chapters should use their judgment and take their specific circumstances into account when planning and preparing for competitions).

Society-Wide Competition Rules Can Be Found At:

<https://www.asce.org/communities/student-members/conferences/rules>.

The Society-wide and Society pilot competitions being hosted at the PSW Student Symposium are:

- ASCE Concrete Canoe Competition
 - AISC/ASCE Student Steel Bridge Competition
 - ASCE Sustainable Solutions
 - ASCE UESI Surveying Competition
 - Timber-Strong Design Build Competition
 - Student Symposium Paper Competition (*Participation is a requirement for advancement to Society-wide competition finals and SSBC National Finals.*)
-

Regional Competition Rules:

Regional Competition Rules can be found on our website:

<https://studentsymposium.asce.org/pacificsouthwest/competitions/>

The Regional competitions being hosted at the PSW Student Symposium are:

- Transportation Design Competition
- Environmental Competition
- Geowall Competition
- Prestressed Concrete Mini Beam Competition



ASCE COMPETITION ELIGIBILITY REQUIREMENTS

Competitions that advance to an ASCE Society-wide Competitions Finals include: ASCE Concrete Canoe Competition, ASCE Sustainable Solutions Competition, and ASCE UESI Surveying Competition.

The AISC/ASCE Student Steel Bridge Competition advances to the SSBC National Finals and follows the eligibility requirements below. See [SSBC Rules](#) for more information.

Invitations to Student Symposia and ASCE Student Civil Engineering Championships/Society-wide Competition Finals are a privilege, not a right. Failure to act professionally can result in letters of reprimand, mandatory behavior management plans, and loss of invitations to further competition for individual institutions and/or entire conferences. Please note that the requirements for eligibility for Society-wide competition finals are more stringent than the requirements for participation at the student symposia competitions.

ELIGIBILITY FOR STUDENT SYMPOSIUM COMPETITION

The following qualifications are required of all ASCE Student Chapters to compete at the Student Symposia Competitions:

An ASCE Student Chapter must:

1. Be in good standing with ASCE:
 - a. Have paid their annual dues, as received by ASCE, no later than the start of their Student Symposium.
 - b. Have submitted their student chapter's full Annual Report or EZ Annual Reporting Form, no later than February 1, 11:59 p.m. EST.

ELIGIBILITY FOR ASCE SOCIETY-WIDE COMPETITION FINALS

The following qualifications are required of all ASCE Student Chapters in order to advance to the ASCE Society-wide Competition Finals:

An ASCE Student Chapter must:

1. Be in good standing with ASCE:
 - a. Have paid their annual dues, as received by ASCE, no later than February 1, 11:59 p.m. EST.
 - b. Have submitted their student chapter's full Annual Report, no later than February 1, 11:59 p.m. EST and have received a minimum score of 25 points out of a possible 100. Student Chapters that submit an EZ annual reporting form do not qualify to advance on to competition finals; and
2. Attend and participate in their assigned Student Symposium as shown through their school's:
 - a. On-time attendance and active participation by a member of the ASCE Student Chapter at the Student Symposium Business Meeting.
 - b. Participation in the Student Symposium Paper Competition, including submission and presentation by a member of the ASCE Student Chapter. Note that any papers/presentations created for any other competition do not count as an entry into the Student Symposium Paper Competition.

Questions regarding edibility should be directed to student@asce.org.



STUDENT SYMPOSIUM PAPER COMPETITION (ELIGIBILITY REQUIREMENT)

This is a mandatory paper submission and presentation for any student chapter participating in the 2024 ASCE PSW Student Symposium that wishes to be eligible to advance to ASCE Society-wide competition finals and SSBC National Finals. Competitions **requiring** this include: **ASCE Concrete Canoe Competition, ASCE Sustainable Solutions Competition, ASCE UESI Surveying Competition, and AISC/ASCE Student Steel Bridge Competition.**

The ASCE Student Symposium Paper Competition emphasizes the importance of being able to write and present a paper as essential communication skills for all engineers and often necessary for advancement in your career.

Participation in the Student Symposium Paper Competition, including submission and presentation by a member of the ASCE Student Chapter, is a requirement to be eligible to advance to an ASCE Society-wide competition finals and SSBC National Finals.

Note that any papers/presentations created for any other competition do not count as an entry into the Student Symposium Paper Competition.

The topic for the ASCE PSW Student Symposium Paper Competition is the Daniel W. Mead Prize for Students Topic:

“Per ASCE’s Code of Ethics, engineers govern their professional careers on the following fundamental principles:

- *create safe, resilient, and sustainable infrastructure;*
- *treat all persons with respect, dignity, and fairness in a manner that fosters equitable*
- *participation without regard to personal identity;*
- *consider the current and anticipated needs of society; and*
- *utilize their knowledge and skills to enhance the quality of life for humanity.*

Civil engineers are responsible for planning, designing, constructing, maintaining, and operating infrastructure while protecting and advancing the health, safety, and welfare of the public. Technology, particularly the use of Artificial Intelligence (AI), has the potential to change engineering in the future and design the built environment for generations. Ethical responsibilities of an engineer may or may not align with the use of AI on engineering projects.

Discuss how engineers need to evaluate their ethical responsibilities as they determine whether or how to use AI to aid in their work.”

Submission deadline is: March 1st, 2024

Submission email/link is: psws2024.hawaii@gmail.com

This topic is the same topic as the Daniel W. Mead Prize for Students. However, the Student Symposium Paper Competition and the Daniel W. Mead Prize for Students are **two separate competitions and must be submitted separately**. The Student Symposium Paper Competition paper is due March 1st and submitted to psws2024.hawaii@gmail.com. The Daniel W. Mead Prize for Students is due March 1st and submitted to student@asce.org.



BUSINESS MEETING (ELIGIBILITY REQUIREMENT)

The Business Meeting is tentatively scheduled to take place on Saturday, April 6, 2024 at 1:30pm. Keep an eye out for the draft business meeting agenda that will be distributed to student chapters for review before the symposium.

Note that the business meeting is officially the business meeting for the Student Conference Board of Delegates. The Board of Delegates consists of two student delegates (preferably a senior or junior in an ASCE leadership position and a sophomore in or aspiring to an ASCE leadership position) and the faculty advisor from each student chapter. Each student delegate must be a member in good standing with their student chapter and the Society. Each student chapter in the Student Conference has one vote. At least one member of your ASCE student chapter must participate. ([See eligibility requirements.](#))

The graphic features a dark blue background with several orange triangles of varying sizes and orientations. The text 'ASCE Pop-Up Leadership Shop' is prominently displayed in white and orange. Below this, an orange banner contains the text 'Coming to Your Regional Symposium' and 'SPRING 2024' in dark blue.

**ASCE Pop-Up
Leadership Shop**

Coming to Your Regional Symposium **SPRING 2024**

Don't miss the opportunity to learn about professional skills you can use now and after graduation to help you get ahead. Pop-Up Leadership Shops, presented by the Committee on Student Members and other Region leaders, will be held throughout the Symposia. Topics include the power of emotional intelligence, professional ethics and conduct, and the pathway to getting the FE/PE. More details will follow in Mailer 3!



HOTEL BLOCK INFORMATION

We are offering two hotel accommodations, available from April 2 to April 6: Holiday Inn Express Waikiki and Ohana Waikiki East by Outrigger. Both offer a base price of \$189 per double-bed room (can sleep 4 people). Please be aware that this rate excludes taxes, additional personal fees, parking, and any other potential charges. For comprehensive details, we recommend contacting each hotel directly. For those planning to stay at the Holiday Inn, please reserve prior to March 24, 2024. For those staying at Outrigger, please reserve before March 1, 2024. Discounted pricing will be recognized for 3 days pre and post-main symposium dates, should you choose to extend your visit.

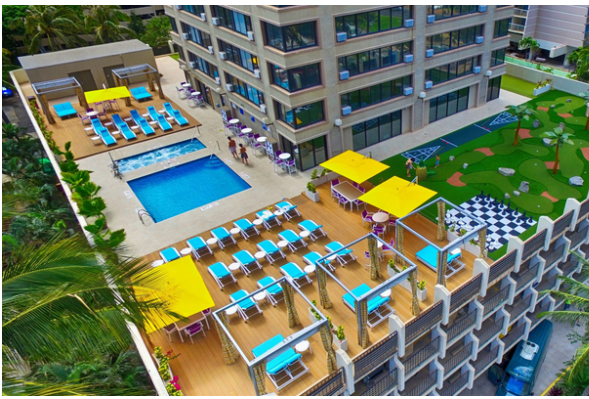

[Holiday Inn Express Waikiki](#)

Address: 2058 Kūhiō Ave., Honolulu, HI 96815

Phone: Use code "ASC" when calling (808) 748-7103 or (808) 714-7104



[Ohana Waikiki East by Outrigger](#)

Address: 150 Ka'iulani Ave, Honolulu, HI 96815