



Dear Western Great Lakes Student Conference,

The ASCE Student Chapters of Marquette University, the Milwaukee School of Engineering, and University of Wisconsin – Milwaukee are excited to be hosting the 2025 ASCE Western Great Lakes Student Symposium on April 10th through April 12th in Milwaukee, Wisconsin. This is your 2025 Symposium Mailer 3, the last of three informational packets to be sent to each of the participating ASCE Student Chapters in our Student Conference.

You can also find updated symposium information at the link below.

<https://studentsymposium.asce.org/western-great-lakes/>

Please carefully read this information and forward copies to the appropriate members in your ASCE Student Chapter and team members for each team competing at the student symposium. Do not delete this mailer as information given within subsequent mailers may not be repeated. Enclosed, you will find the following information:

- Mailer 3 Confirmation,
- Business Meeting information,
- Daily Schedule,
- Maps, directions, and parking information,
- Non-competition event information,
- Competition presentation and display information,
- Remind updates information,
- Final presentation schedules,
- Final deadlines,
- Society and regional competition information,
- Student Symposium Paper Competition information,
- ASCE Society Competition eligibility requirements,
- Hotel information,
- Safety-first culture information,
- Competition safety information, and
- Sponsor recognition

If you have any questions, feel free to contact us at our general student symposium e-mail address, listed below. All symposium information such as events, mailers, policies, rules, etc. will be posted on our [website](#). Please reach out with questions to 2025wgls@gmail.com.



We look forward to your participation in the 2025 ASCE Western Great Lakes Student Symposium and providing an opportunity to engage with other student chapters and ASCE Region Leadership.

Sincerely,
Simon Mathiowetz
Executive Chair,
Marquette University

Bryan Berres
Executive Chair,
Milwaukee School
of Engineering

Omar Nevarez
Executive Chair,
University of Wisconsin
- Milwaukee

Mailer Receipt Form

Follow the link below to complete the Mailer 3 Receipt Confirmation due no later than
April 4, 2025.

[Mailer 3 Receipt Confirmation Link – Western Great Lakes](#)

Remind Updates Information

We will use remind to send any updates that we have to everyone below is the link to join the updates

[JOIN ASCE WGL REMIND](#)



Business Meeting (Eligibility Requirement)

The draft business meeting agendas will be emailed to chapter presidents and faculty advisors prior to the week of symposium. If you have agenda items and/or motions that your student chapter would like to be included in the agenda, please submit them to 2025wgls@gmail.com by **April 4, 2025**.

Note that the business meeting is officially the business meeting for the Student Conference Board of Delegates. The Board of Delegates consists of two student delegates (preferably a senior or junior in an ASCE leadership position and a sophomore in or aspiring to an ASCE leadership position) and the faculty advisor from each student chapter. Each student delegate must be a member in good standing with their student chapter and the Society. Each student chapter in the Student Conference has one vote.

At least one member of your ASCE student chapter must participate in the Business Meeting as part of the eligibility requirements to advance to finals for Concrete Canoe, Steel Bridge, Sustainable Solutions, and Surveying.

[Click here for ASCE Eligibility Requirements](#)

Summary of Deadlines

Mailer 3 Receipt Form

April 4, 2025

2025 ASCE Western Great Lakes Student Symposium

April 10-12, 2025

Daily Schedule

Thursday, April 10th		
Event	Time	Location
Registration Check-in	4-9 PM	Marquette Union Sports Annex
Bowling	4-8 PM	Marquette Union Sports Annex
Quiz Bowl	6-7 PM	Marquette O'Brien Hall 150
Symposium Paper	6:30-10 PM	Marquette Engineering Hall 236
Concrete Canoe Captains Meeting	8-9 PM	Marquette Engineering Hall 136
GeoWall Captains Meeting	8-9 PM	Marquette Engineering Hall 423

Friday, April 11th		
Event	Time	Location
Concrete Canoe and Surveying	5 AM-4 PM	Lakeshore State Park
Surveying Field Tasks	7:30 AM -4 PM	Lakeshore State Park
Lunch	12:00 – 1:00 PM	Lakeshore State Park
Concrete Cornhole	10 AM-12 PM	Lakeshore State Park
GeoWall	6-9 PM	Marquette Engineering Hall 021
Volleyball	6-9 PM	Marquette Wellness + Helfaer Recreation Center
Steel Bridge Captains Meeting	8-9 PM	Marquette Engineering Hall 136
Construction Institute Captains Meeting	8-9 PM	Marquette Engineering Hall 236
Sustainable Solutions Captains Meeting	8-9 PM	Marquette Engineering Hall 323

Daily Schedule Cont.

Saturday, April 12th		
Event	Time	Location
Steel Bridge	5:00 AM-4:00 PM	MSOE Kern Center
Breakfast	7:00 – 8:00 AM	MSOE Kern Center
Sustainable Solutions	7:00 - 10:00 AM	MSOE Diercks Hall – Room 110
Construction Institute	7:00 - 11:00 AM	MSOE Diercks Hall – Room 129
Concrete Canoe Presentations	9:30 AM - 2:00 PM	MSOE Diercks Hall – NVIDIA Auditorium
Pop Up Workshops	11:00 AM - 3:00 PM	MSOE Diercks Hall – Room 110
Lunch	11:00 AM – 1:00 PM	MSOE Kern Center
Sustainable Solutions Display	12:00 - 1:00 PM	MSOE Diercks Hall - Atrium
Surveying Display	10:30 -11:30 AM	MSOE Diercks Hall - Atrium
Survey Presentations	11:30 AM -12:30 PM	MSOE Diercks Hall – Room 129
Business Meeting	5:00 - 6:00 PM	UWM Student Union – Room E240
Career Fair	5:00 - 6:45 PM	UWM Student Union – Union Ballroom W195
Banquet	7:00 - 10:00 PM	UWM Student Union – Wisconsin Room E245

Milwaukee Overview Map

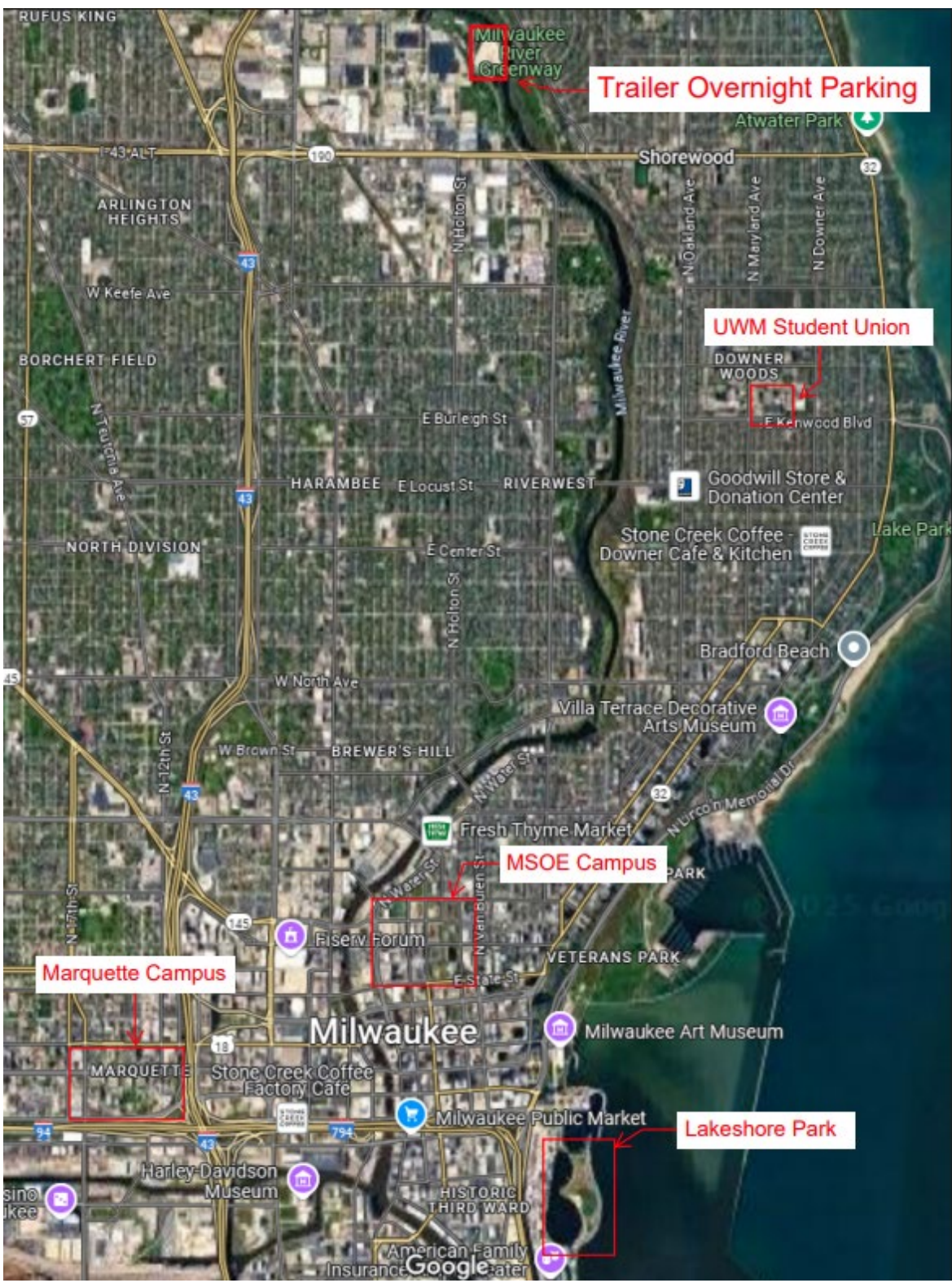

Marquette Campus

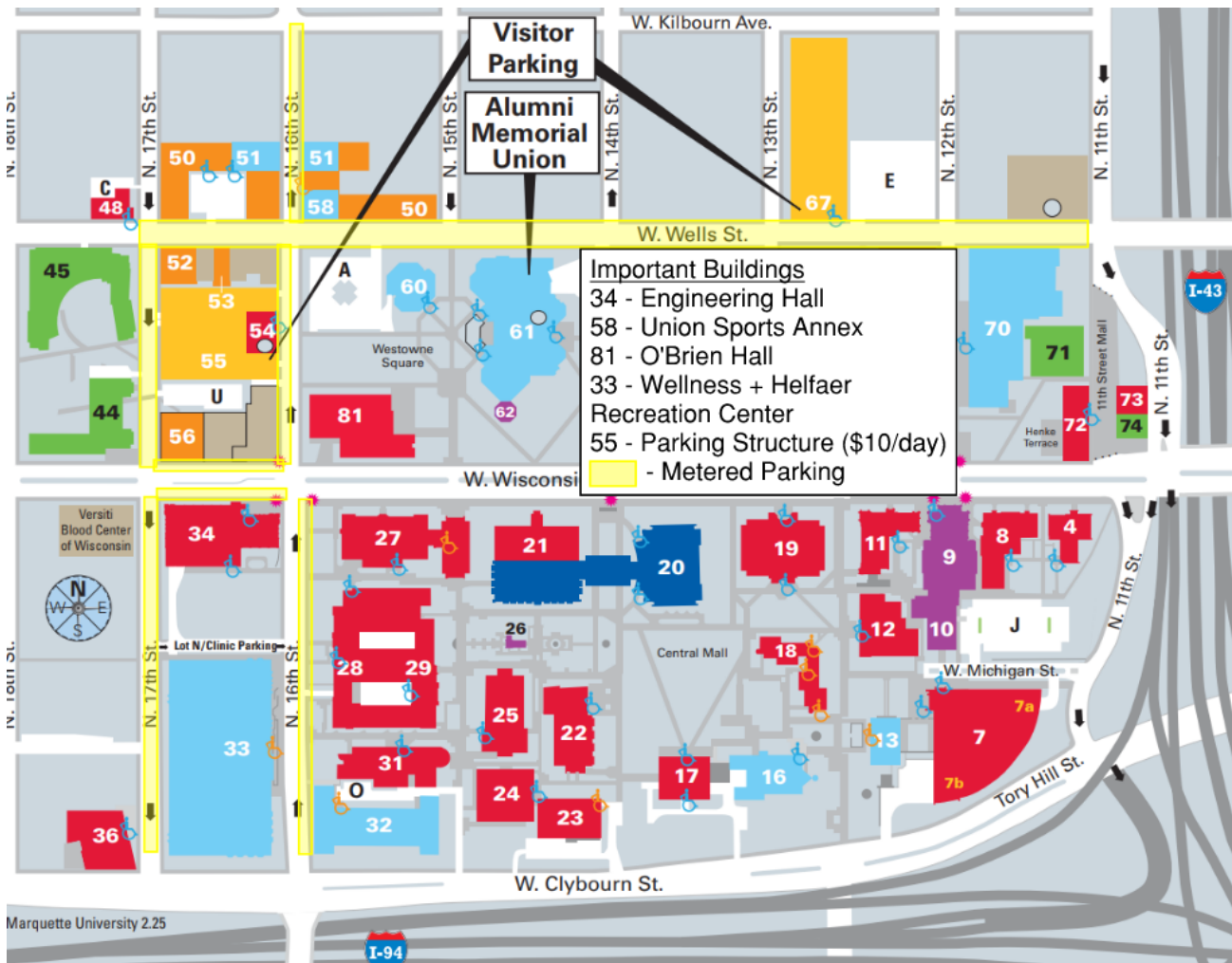

Marquette Addresses

- Engineering Hall - 1637 W Wisconsin Ave, Milwaukee, WI 53233
- Marquette University Union Sports Annex - 804 N 16th St, Milwaukee, WI 53233
- O'Brien Hall - 1530 W Wisconsin Ave, Milwaukee, WI 53233
- Wellness + Helfaer Recreation Center - 525 N 16th St, Milwaukee, WI 53233
- 16th St Parking Structure, 749 N 16th St, Milwaukee, WI 53233 (enter on 16th St)

Marquette Engineering Hall

Address: 1637 W Wisconsin Ave, Milwaukee, WI 53233

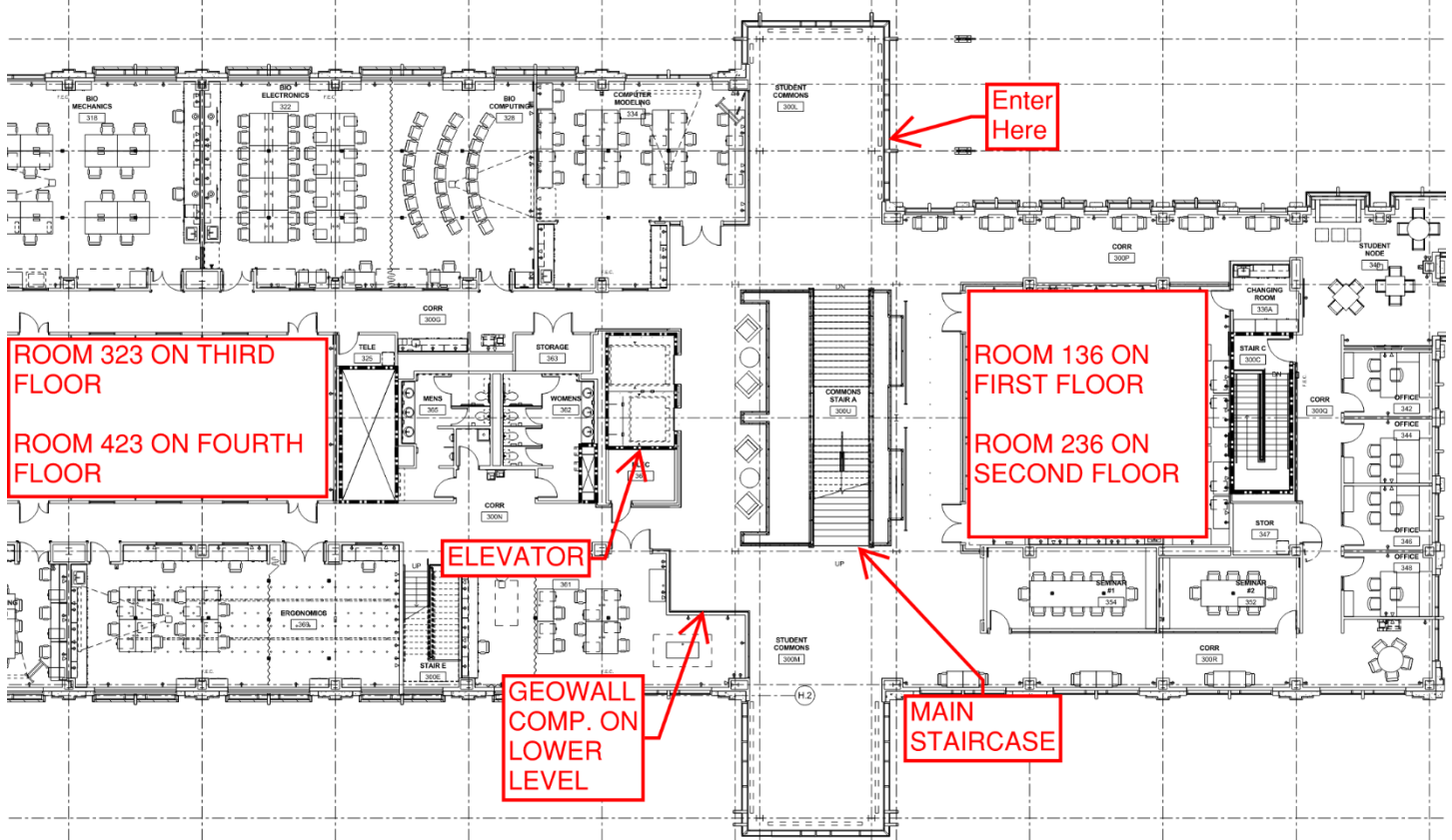

Lakeshore State Park Overview

Address: 500 N Harbor Dr, Milwaukee, WI 53202



As shown below, access Lakeshore State Park from the south side and going around the Summerfest grounds



Lakeshore State Park Address: 500 N Harbor Dr, Milwaukee, WI 53202
Note: You may find it helpful to set your directions to the “Milwaukee Pierhead Lighthouse” to get to get out to the Park.
Canoe Trailer Parking Address: 650 E Erie St. Milwaukee WI 53202

MSOE Campus Overview



AERIAL MAP OF MSOE CAMPUS PARKING OPTIONS

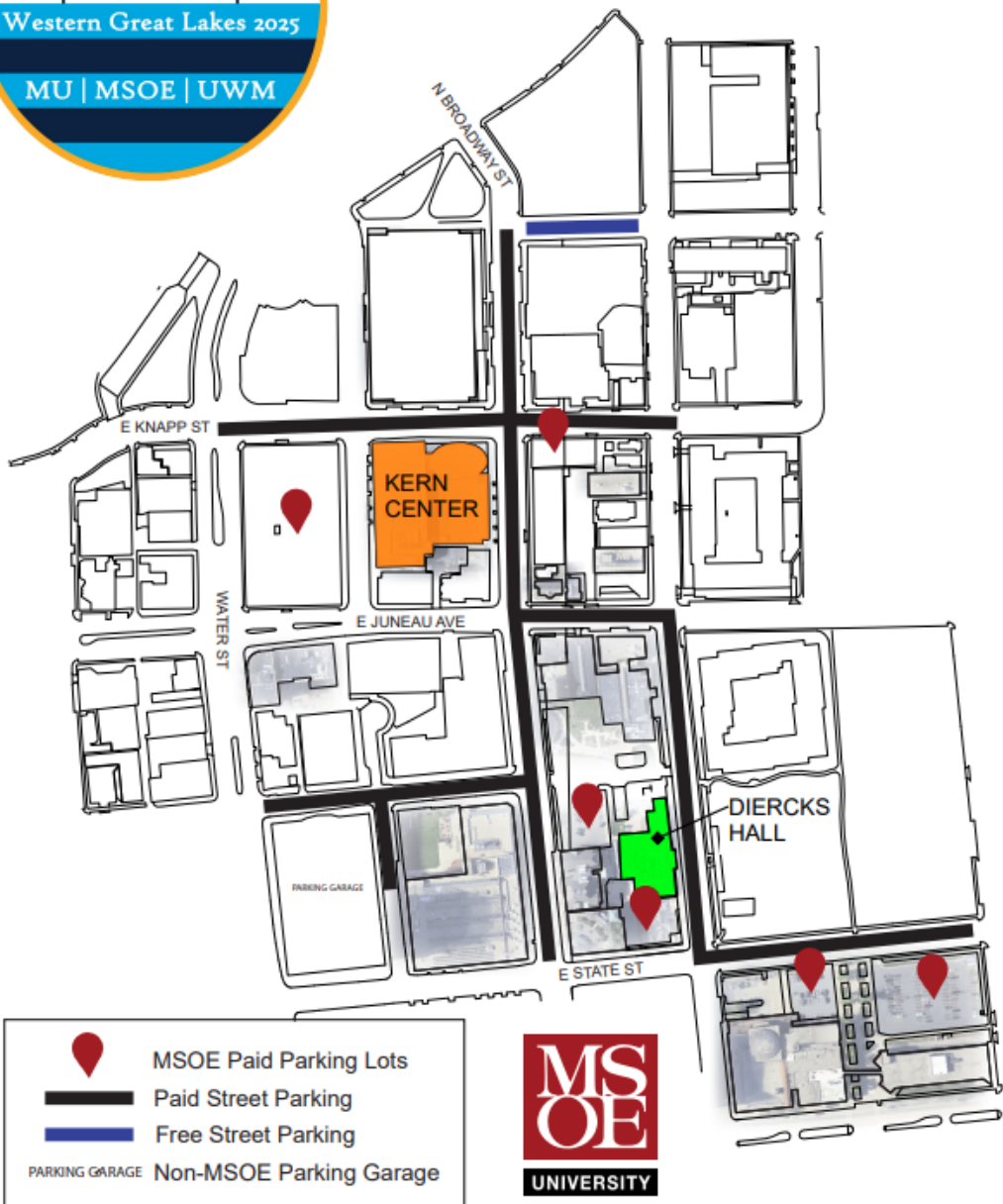

MSOE Diercks Hall

Address: 1025 N Milwaukee St, Milwaukee, WI 53202



AERIAL MAP OF MSOE DIERCKS HALL

LOCATION OF CONCRETE CANOE, SURVEYING, SUSTAINABLE SOLUTIONS, AND CONSTRUCTION INSTITUTE PRESENTATIONS AND POP UP WORKSHOPS



- ① ROOM 110 - Sustainable Solutions Presentations and Pop Up Workshops
- ② ATRIUM - Sustainable Solutions and Surveying Displays
- ③ ROOM 129 - Construction Institute and Surveying Presentations
- ④ NVIDIA AUDITORIUM - Concrete Canoe Presentations





MSOE Kern Center

Address: 1245 N Broadway, Milwaukee, WI 53202



AERIAL MAP OF MSOE KERN CENTER

LOCATION OF STEEL BRIDGE COMPETITION

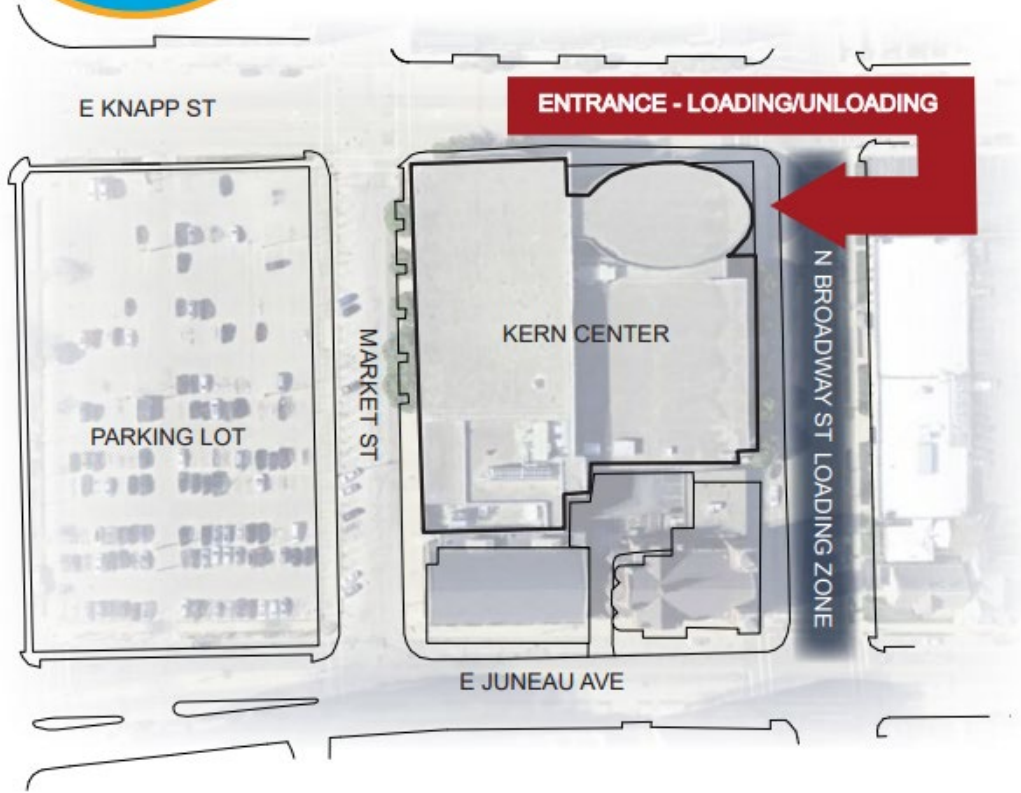

NOTE:
Teams may unload and load their bridges at the entrance, located on the east side of the Kern Center. Parking lanes along N Broadway St. may be used as a loading zone.



UWM Student Union Overview:

Address: 2200 E Kenwood Blvd, Milwaukee, WI 53211

Parking



Ground Floor

UNIVERSITY OF WISCONSIN - MILWAUKEE
Campus Planning
UWM UNION
Level G
Revised: 08/08/2023

Room No.	Room Name	Room No.	Room Name	Room No.	Room Name	Room No.	Room Name	Room No.	Room Name
EG001	EG001	EG002	EG002	EG003	EG003	EG004	EG004	EG005	EG005
EG006	EG006	EG007	EG007	EG008	EG008	EG009	EG009	EG010	EG010
EG011	EG011	EG012	EG012	EG013	EG013	EG014	EG014	EG015	EG015
EG016	EG016	EG017	EG017	EG018	EG018	EG019	EG019	EG020	EG020
EG021	EG021	EG022	EG022	EG023	EG023	EG024	EG024	EG025	EG025
EG026	EG026	EG027	EG027	EG028	EG028	EG029	EG029	EG030	EG030
EG031	EG031	EG032	EG032	EG033	EG033	EG034	EG034	EG035	EG035
EG036	EG036	EG037	EG037	EG038	EG038	EG039	EG039	EG040	EG040
EG041	EG041	EG042	EG042	EG043	EG043	EG044	EG044	EG045	EG045
EG046	EG046	EG047	EG047	EG048	EG048	EG049	EG049	EG050	EG050
EG051	EG051	EG052	EG052	EG053	EG053	EG054	EG054	EG055	EG055
EG056	EG056	EG057	EG057	EG058	EG058	EG059	EG059	EG060	EG060
EG061	EG061	EG062	EG062	EG063	EG063	EG064	EG064	EG065	EG065
EG066	EG066	EG067	EG067	EG068	EG068	EG069	EG069	EG070	EG070
EG071	EG071	EG072	EG072	EG073	EG073	EG074	EG074	EG075	EG075
EG076	EG076	EG077	EG077	EG078	EG078	EG079	EG079	EG080	EG080
EG081	EG081	EG082	EG082	EG083	EG083	EG084	EG084	EG085	EG085
EG086	EG086	EG087	EG087	EG088	EG088	EG089	EG089	EG090	EG090
EG091	EG091	EG092	EG092	EG093	EG093	EG094	EG094	EG095	EG095
EG096	EG096	EG097	EG097	EG098	EG098	EG099	EG099	EG100	EG100
EG101	EG101	EG102	EG102	EG103	EG103	EG104	EG104	EG105	EG105
EG106	EG106	EG107	EG107	EG108	EG108	EG109	EG109	EG110	EG110
EG111	EG111	EG112	EG112	EG113	EG113	EG114	EG114	EG115	EG115
EG116	EG116	EG117	EG117	EG118	EG118	EG119	EG119	EG120	EG120
EG121	EG121	EG122	EG122	EG123	EG123	EG124	EG124	EG125	EG125
EG126	EG126	EG127	EG127	EG128	EG128	EG129	EG129	EG130	EG130
EG131	EG131	EG132	EG132	EG133	EG133	EG134	EG134	EG135	EG135
EG136	EG136	EG137	EG137	EG138	EG138	EG139	EG139	EG140	EG140
EG141	EG141	EG142	EG142	EG143	EG143	EG144	EG144	EG145	EG145
EG146	EG146	EG147	EG147	EG148	EG148	EG149	EG149	EG150	EG150
EG151	EG151	EG152	EG152	EG153	EG153	EG154	EG154	EG155	EG155
EG156	EG156	EG157	EG157	EG158	EG158	EG159	EG159	EG160	EG160
EG161	EG161	EG162	EG162	EG163	EG163	EG164	EG164	EG165	EG165
EG166	EG166	EG167	EG167	EG168	EG168	EG169	EG169	EG170	EG170
EG171	EG171	EG172	EG172	EG173	EG173	EG174	EG174	EG175	EG175
EG176	EG176	EG177	EG177	EG178	EG178	EG179	EG179	EG180	EG180
EG181	EG181	EG182	EG182	EG183	EG183	EG184	EG184	EG185	EG185
EG186	EG186	EG187	EG187	EG188	EG188	EG189	EG189	EG190	EG190
EG191	EG191	EG192	EG192	EG193	EG193	EG194	EG194	EG195	EG195
EG196	EG196	EG197	EG197	EG198	EG198	EG199	EG199	EG200	EG200

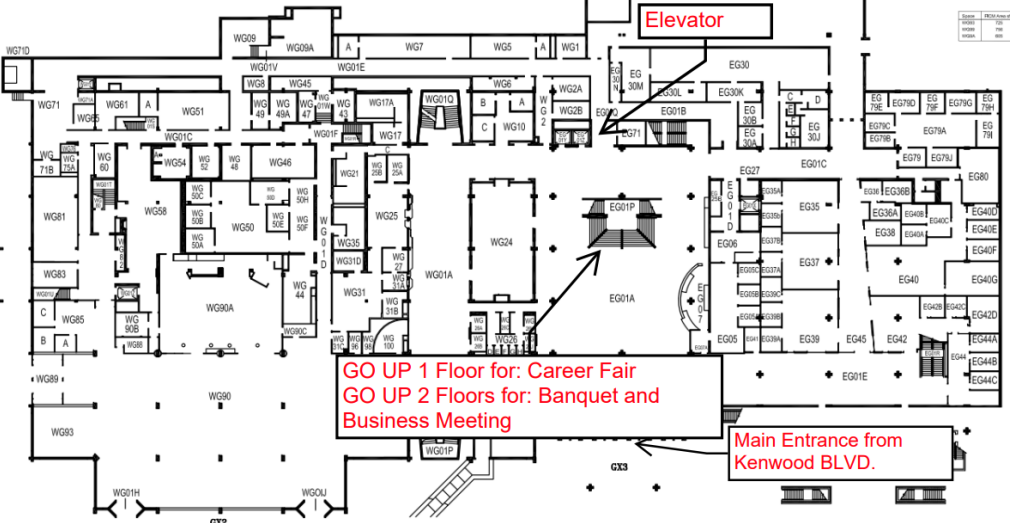

Trailer Overnight Parking Overview

UWM UPARK Capitol/Humboldt Lot

Address: N Humboldt Blvd, Milwaukee, WI 53212

Entrance/Exit



UPARK Lot:





Public Transportation in Milwaukee

There is a good amount of public transportation available through the Milwaukee County Transit System. Google or Apple Maps and the [UMO App](#) are great ways to look at the bus system. Depending on where you are staying, this may be even easier than parking at events. [Linked here](#) is a static map of the bus routes

Non-Competition Event Information

Registration Check-in:

Date: April 10th

Time: 4:00 PM – 9 PM

Location: Marquette Union Sports Annex, 804 N 16th St, Milwaukee, WI 53233

Join us for check-in to kick-off the 2025 Western Great Lakes Student Symposium and bowling at The Annex.

Captains Meetings:

Date: April 10th and 11th

Time: 8 PM – 9 PM

Location: Marquette Engineering Hall, 1637 W Wisconsin Ave, Milwaukee, WI 53233

Join us for captain's meetings for Concrete Canoe and Geowall on Thursday and captain's meetings for Steel Bridge, Sustainable Solutions, and Construction Institute on Friday. Classroom locations are shown in the daily schedule.

Cost Estimates based on the AISC Template will be due during the SSBC captain's meeting



ASCE Pop-Up Workshops:

Date: April 12th

Time: 11 AM – 3 PM

Location: Diercks Hall – Room 110 -1025 N
Milwaukee St, Milwaukee, WI 53202

Join us for 1-hour Pop-Up workshops to grow your personal and professional skills that you can use after graduation, presented by the Committee on Student Members and other region leaders.



Pop-Up #1: 11 AM – What is Your Personality Type? Understanding Each Other

Pop-Up #2: 1 PM – What Would You Do? Ethics & Professional Conduct

Pop-Up #3: 2 PM – The FE exam and The Path to the PE

Career Fair:

Date: April 12th

Time: 5:00 PM – 6:45 PM

Location: UWM Student Union – Union Ballroom W195 - 2200 E Kenwood Blvd, Milwaukee, WI 53211

Connect with industry professionals at the 2025 ASCE Western Great Lakes Student Symposium Career Fair. This event will be a great opportunity to expand your professional network and explore current job and internship opportunities.

Business Meeting:

Date: April 12th

Time: 5:00 PM – 6:00 PM

Location: UWM Student Union – Room E240 - 2200 E Kenwood Blvd, Milwaukee, WI 53211

The annual business meeting will discuss the region's state and future host schools and review this year's symposium. All attending chapters must send at least one representative to the business meeting. Attendance will be taken.



Awards Banquet:

Date: April 12th

Time: 7:00 PM – 10:00 PM

Location: UWM Student Union – Wisconsin Room E245 - 2200 E Kenwood Blvd,
Milwaukee, WI 53211

Celebrate the culmination of the 2025 ASCE Western Great Lakes Student Symposium with an unforgettable Awards Banquet! Join us in UWM's Wisconsin Room for an evening of recognition and honor as we applaud the exceptional contributions of students who have dedicated time to representing their university. The dress code for this event is business attire.

Breakfast and Lunch:

Date: April 11th and 12th

Time: 11 AM – 1 PM

Lunch will be provided to registered attendees on Friday, April 11th at Lakeshore State Park at 12:00 PM. Breakfast and lunch will be provided to registered attendees on Saturday, April 12th at the MSOE Kern Center from 7-8AM and 11AM – 1PM, respectively. Food provided at the 2025 ASCE Western Great Lakes Symposium will account for all dietary restrictions of the registered attendees.

Competition Presentation & Display Information

All Competitions: Each student team that presents is required to bring their digital presentation on a USB. The host will provide laptop and projector equipment.

Please see the competition rules for full details. If there is a discrepancy between the rules and the information listed below, the competition rules are to be followed.

ASCE Concrete Canoe Competition: Teams are responsible for providing all necessary materials for the display portion of the competition. ([Section 7: Prototype Display Requirements](#)). Teams should bring presentations on a thumb drive for the technical presentation ([Section 8: Technical Presentation](#)).



AISC-ASCE Student Steel Bridge Competition: Teams are responsible for providing all necessary materials for the aesthetic display portion of the competition. ([Section 6.2.1](#))

Surveying Competition:

Topographic Map Display: It is the responsibility of each team to bring one (1) 24-inch by 36-inch paper copy set of the topographic mapping project to the symposium, which will be used for public display at the student symposium ([Section 7.3, Paper Copy Submittals](#)). The paper copy set shall be submitted to the student symposium host at check-in.

(This copy is for the public display and does not replace the required online submission due on February 24, 2025, by 5:00 pm EST.)

- Teams are encouraged to bring a standard 6ft tablecloth displaying your school's name, logo, or chapter name (*not required*).
- Teams should plan to stay with their topo map public display to discuss their project with spectators.

Field Task Equipment: Please refer to [Appendix D, Equipment List, in the rules](#) for a full list of required items for the competition. All items must be supplied by each individual team at the symposium competition.

Sustainable Solutions:

Poster Session: Teams will be responsible for providing their own easel for the poster presentation. You can find standard 63" poster board easels online. Easel [Example](#).

- Teams will be expected to stay with their poster during the display to discuss their project with spectators.

ASCE Construction Institute Competition

All teams should come prepared with a laptop. Laptops or computers will not be provided at the competition. One per team is sufficient, but it is recommended that each participating student brings a laptop.

Student Symposium Paper Competition

Students should have submitted their presentation ahead of the of the Student Symposium per the Symposium Paper Rulebook.



Competition Schedules

Symposium Paper Presentations

Date: Thursday, April 10

Location: Marquette - Engineering Hall – Room 236

Address: 1025 N Milwaukee St, Milwaukee, WI 53202

Please arrive and depart at the breaks in the schedule, so we can keep distractions to a minimum and be efficient as possible with our time.

<u>Event</u>	<u>Time</u>	<u>School</u>	
Set-up and Prep	6:00 - 6:30 PM		
Presentations	6:30 PM	Lakehead	
	6:40 PM	UIUC	
	6:50 PM	UW - Platteville	
	7:00 PM	Marquette	
	Break	7:10 PM	
		7:20 PM	UW – Madison
		7:30 PM	MSOE
		7:40 PM	Olivet Nazarene
	Break	7:50 PM	UW - Milwaukee
		8:00 PM	
8:10 PM		UMN	
8:20 PM		NDSU	
8:30 PM		Bradley	
8:40 PM		Northwestern	
8:50 PM		UIC	
Break		9:00 PM	
	9:10 PM	IIT	
	9:20 PM	St. Thomas	
	9:30 PM	UMN – Twin Cities	
	9:40 PM	UND	



Concrete Canoe Race Day

Date: Friday, April 11

Location: Lakeshore State Park

Address: 500 N Harbor Dr, Milwaukee, WI 53202

<u>Event</u>	<u>Time</u>	<u>School</u>
Unloading and Set-up Group 1	5:00 - 5:30 AM	See Chart Below for Groups
Unloading and Set-up Group 2	5:30 – 6:00 AM	See Chart Below for Groups
Unloading and Set-up Group 3	6:00 – 6:30 AM	See Chart Below for Groups
Unloading and Set-up Group 4	6:30 – 7:00 AM	See Chart Below for Groups
Aesthetics Judging	6:30 – 9:15 AM	All Teams
Swamp Test	7:30 – 9:30 AM	All Teams
Men's and Women's Slalom	9:30 – 10:45 AM	All Teams*
Lunch	12:00 – 1:00 PM	All Teams
Men's Sprints	1:00 PM – 2:00 PM	All Teams
Women's Sprints	2:00 PM – 3:00 PM	All Teams
Co-ed Sprints	3:00 – 4:00 PM	All Teams
Durability	After Co-ed Race	All Teams
Loading	After Dismissal	All Teams

Unloading Groups

Note: Groups will have to drive through the park on a one-way. Please be prompt with your arrival with your full group to unload your canoe and move your vehicle in the designated time frame.

Group 1: Marquette, St. Thomas, MSOE

Group 2: UW Platteville, Northwestern, UW Madison

Group 3: UIC, UIUC, UMN – Twin Cities,

Group 4: UMD, Bradley

***Note:** To be as efficient as possible (and make fewer heavy canoe carries to the water), for the Men's and Women's Slalom races, we will race in the following order: Group 1 men then Group 1 Women, Group 2 Men, Group 2 Women (and so on).

Note: The timeline of events for Concrete Canoe will be adjusted to keep the safety of all individuals in mind as well as running efficiently; the order of events will remain the same.

Note: The order of all parts of the event will run in the order of the groups. Group 1 will start aesthetics judging while other teams are still unloading. Group 1

Note: Bring Waders, water shoes, towels, blankets, and lawn chairs. We are on the shores of Lake Michigan, so it can be windy and cold. **BE PREPARED!**



Concrete Cornhole

Date: Friday, April 11

Location: Lakeshore State Park

Address: 500 N Harbor Dr, Milwaukee, WI 53202

<u>Event</u>	<u>Time</u>	<u>School</u>
Set-up	10:00 – 10:30 AM	All Teams
Aesthetics Judging	10:30 – 11:00 AM	All Teams
Game Play	11:00 AM – 12:00 PM	Order Shown Below





Surveying

Date: Friday, April 11

Location: Lakeshore State Park

Address: 500 N Harbor Dr, Milwaukee, WI 53202

<u>Event</u>	<u>Time</u>	<u>School</u>
Arrival and Set-up	7:30 – 8:00 AM	All Teams
Captain's meeting	8:00 - 8:30 AM	All Teams
Field Tasks	8:30 AM – 12:00 PM	All Teams
Lunch	12:00 PM – 1:00 PM	All Teams
Field Tasks	1:00 – 4:00 PM	All Teams
Surveying Display (Saturday)	10:30 -11:30 AM	MSOE Diercks Hall - Atrium
Survey Presentations (Saturday)	11:30 AM -12:30 PM	MSOE Diercks Hall – Room 129

Note: The Surveying Captain's meeting will take place during the morning of the Survey Competition. Field Tasks will be announced at the captain's meeting, as well as the order of events.

Volleyball

Date: Friday, April 11

Location: Marquette – Wellness + Helfaer Recreation Center

Address: 525 N 16th St, Milwaukee, WI 53233





GeoWall

Date: Friday, April 11

Location: Marquette – Engineering Hall – Room 021

Address: 1637 W Wisconsin Ave, Milwaukee, WI 53233

<u>Event</u>	<u>Time</u>	<u>School</u>
Set-up and Prep	6:00-6:30 PM	
Fabrication	6:30 – 6:45 PM	All teams
Wall Assembly	6:45 – 7:00 PM	Bradley
Construction and Loading	7:00 PM	UMN – Twin Cities
	7:30 PM	UMD
	8:00 PM	Bradley

Concrete Canoe Presentations

Date: Saturday, April 12

Location: MSOE - Diercks Hall – NVIDIA Auditorium

Address: 1025 N Milwaukee St, Milwaukee, WI 53202

<u>Event</u>	<u>Time</u>	<u>School</u>
Set-up and Prep	9-9:30 AM	
Presentations	9:30 AM	UIUC
	9:45 AM	Bradley
	10:00 AM	St. Thomas
	10:15 AM	Northwestern
	10:30 AM	Marquette
	10:45 AM	UMD
	11:00 AM	UW – Madison
	11:15 AM	UW – Platteville
	11:30 AM	UMN – Twin Cities
	11:45 AM	UIC
	12:00 PM	MSOE



Steel Bridge

Date: Saturday, April 12

Location: MSOE – Kern Center

Address: 1245 N Broadway, Milwaukee, WI 53202

<u>Event</u>	<u>Time</u>	<u>School</u>
Unload, Set-up, and Check-in	5:00 – 6:00 AM	All Teams
Aesthetics Construction	6:00 AM	All Teams
Aesthetics Judging	6:30 – 7:30 AM	All Teams
Construction	7:30 AM – 4:00 PM	Order Shown Below
Lunch	11:00 AM – 1:00 PM	

There will be three construction lanes, three vertical load testing lanes, and one horizontal load testing lane. Whenever one school finishes construction, the next team will begin setting up in the next available lane. Each construction sequence will take roughly 30 minutes. The order of construction will be as follows:

1. Milwaukee School of Engineering
2. University of Wisconsin-Platteville
3. University of North Dakota
4. Marquette University
5. Bradley University
6. University of Wisconsin-Milwaukee
7. Lakehead University
8. Illinois Institute of Technology
9. University of Illinois at Chicago
10. University of Illinois at Urbana-Champaign
11. Olivet Nazarene University
12. University of Minnesota Duluth
13. Northwestern University
14. University of St. Thomas
15. University of Minnesota-Twin Cities
16. North Dakota State University
17. University of Wisconsin-Madison



Sustainable Solutions

Date: Saturday, April 12

Location: MSOE - Diercks Hall – Room 110

Address: 1025 N Milwaukee St, Milwaukee, WI 53202

<u>Event</u>	<u>Time</u>	<u>School</u>
Interviews	7:00 AM	UW – Platteville
(15 min / interview)	7:20 AM	IIT
	7:40 AM	Northwestern
	8:00 AM	UMN – Twin Cities
Break	8:20 AM	
	8:40 AM	UIUC
	9:00 AM	UIC
	9:20 AM	UW – Madison
Displays	12 – 1 PM	All Teams

Construction Institute

Date: Saturday, April 12

Location: MSOE - Diercks Hall – Room 129

Address: 1025 N Milwaukee St, Milwaukee, WI 53202

<u>Event</u>	<u>Time</u>	<u>School</u>
Check-In	7:00 AM	All Teams
Announcements	7:15 AM	All Teams
Link to Challenges and Product Documents Accessible on Cerberus	7:30 AM	All Teams
All Responses Turned In	9:59 AM	All Teams
Presentations	10:10 AM	UMN – Twin Cities
Presentations	10:25 AM	UIUC
Presentations	10:40 AM	Bradley



Society-Wide Competition Information

Society-wide competitions at the 2025 ASCE Western Great Lakes Student Symposium.

Society-wide Competitions

ASCE Sustainable Solutions Competition



ASCE UESI Surveying Competition



AISC/ASCE Student Steel Bridge Competition



ASCE Concrete Canoe Competition



Society Pilot Competitions

Society Pilot competitions at the 2025 ASCE Western Great Lakes Student Symposium.

Society Pilot Competitions

ASCE Construction Institute Competition



Society competition rules can be found at:

<https://www.asce.org/communities/student-members/conferences/rules>



Regional Competition Information

Regional competitions at the 2025 ASCE Western Great Lakes Student Symposium

<p>Student Symposium Paper Competition <i>Participation is a requirement for advancement to Society-wide competition finals and SSBC National Finals</i></p>	<p>Concrete Cornhole Competition <i>This competition presents students with the opportunity to design and construct their own cornhole boards out of concrete</i></p>	<p>GeoWall Competition <i>The objective of the GeoWall competition is to design and build a model mechanically stabilized Earth (MSE) retaining wall.</i></p>	<p>Volleyball <i>A casual volleyball tournament will be offered as a fun social event</i></p>
<p>Quiz Bowl <i>In a Jeopardy-inspired format, students will be quizzed on their knowledge of civil engineering trivia and problems ranging from topics like Famous Structures to Historical Figures.</i></p>	<p>Scavenger Hunt <i>Students will be challenged to explore and find landmarks through the symposium locations while being tasked with answering civil engineering-related problems or challenges.</i></p>		

Scavenger Hunt

The scavenger hunt will take place on the Marquette and MSOE Campuses on Thursday, Friday, and Saturday. The hints will be found on the [Symposium website](#) on Thursday, April 10. You will get to take photos with landmarks on each campus.



Student Symposium Paper Competition

The ASCE Student Symposium Paper Competition emphasizes the importance of being able to write and present a paper as essential communication skills for all engineers and often necessary for advancement in your career. The competition consists of a paper submission and a presentation at the student symposium.

Paper Submission deadline: February 28th, 2025

This topic is the same as the [Daniel W. Mead Prize for Students](#). However, the Student Symposium Paper Competition and the Daniel W. Mead Prize for Students are two separate competitions and **must be submitted separately**. The Student Symposium Paper Competition paper is due February 28th, 2025 and submitted to 2025wgls@gmail.com. The [Daniel W. Mead Prize for Students](#) is due March 1st and submitted to student@asce.org.

ASCE Society Competition Eligibility Requirements

Competitions that advance to an ASCE Society-wide Competition Finals include the ASCE Concrete Canoe Competition, ASCE Sustainable Solutions Competition, and ASCE UESI Surveying Competition. The AISC/ASCE Student Steel Bridge Competition advances to the SSBC National Finals and follows the eligibility requirements below. See [SSBC Rules](#) for more information.

The purpose of student competitions is to provide student members career-enrichment opportunities to gain hands-on, practical experience and leadership skills. Society Competitions are an important and special opportunity to showcase the engineering and professional skills of student teams. As such, mutual respect is required for all stakeholders, including competitors, judges, hosts, and guests. Invitations to the Student Symposia and the ASCE Student Civil Engineering Championships/Society-wide Competition Finals are a privilege, not a right. Failure to act professionally can result in sanctions, disqualifications, and loss of invitations. Please note that the requirements for eligibility for Society-wide competition finals are more stringent than the requirements for participation at the student symposia competitions.



Eligibility for [Student Symposium Competition](#)

The following qualifications are required of all ASCE Student Chapters to compete at the Student Symposia Competitions:

An ASCE Student Chapter must:

1. Be in good standing with ASCE:
 - a. Have paid their annual dues, as received by ASCE, **no later than the start of their Student Symposium.**
 - b. Have submitted their student chapter's full Annual Report or EZ Annual Reporting Form **no later than February 1, 11:59 p.m. EST.**

Eligibility for [ASCE Society-wide Competition Finals](#)

The following qualifications are required of all ASCE Student Chapters in order to advance to the ASCE Society-wide Competition Finals:

An ASCE Student Chapter must:

1. Be in good standing with ASCE:
 - a. Have paid their annual dues, as received by ASCE, no later than February 1, 11:59 p.m. EST.
 - b. Have submitted their student chapter's **full Annual Report, no later than February 1, 11:59 p.m. EST, and have received a minimum score of 25 points out of a possible 100. Student Chapters that submit an EZ annual reporting form do not qualify** to advance to competition finals; and
2. Attend and participate in their assigned Student Symposium as shown through their school's:
 - a. On-time attendance and active participation by a member of the ASCE Student Chapter at the Student Symposium Business Meeting.
 - b. Participation in the Student Symposium Paper Competition, including submission and presentation by a member of the ASCE Student Chapter. Note that any papers/presentations created for any other competition do not count as an entry into the Student Symposium Paper Competition.

Questions regarding eligibility should be directed to student@asce.org.



Hotel Information

Please visit <https://www.visitmilwaukee.org/> to find accommodations for your chapter. Suggested hotels near Marquette University, MSOE, and UW-Milwaukee campuses would be:

- [Days Inn & Suites by Wyndham Milwaukee](#)
- [Hampton Inn & Suites Milwaukee Downtown](#)
- [Hyatt Place Milwaukee Downtown](#)
- [Homewood Suites by Hilton Milwaukee Downtown](#)
- [Hyatt Regency Milwaukee](#)
- [DoubleTree by Hilton Hotel Milwaukee Downtown](#)
- [Hilton Garden Inn Milwaukee Downtown](#)

Safety-First Culture Information

ASCE and the host Universities are encouraging a Safety-First Culture during the student symposium. We encourage all symposium participants to embrace this concept by thinking about safety in their activities coming to, returning from, and while at our symposium. We want **every** symposium participant to return home safe and healthy.

To generate a Safety-First Culture, we have designated Dr. Andrew Sen (Andrew.sen@marquette.edu) as our symposium safety officer for Friday, April 11th and Trevor Schmitt (schmittt@msoe) as our symposium safety officer for Saturday, April 12th. Further, be on the lookout for safety information at the symposium, such as the location of first-aid supplies, who in the crowd has first-aid training and Safety Moments.

What is a Safety Moment? A Safety Moment consists of a quick discussion on an activity-specific, site-specific, or general safety topic. The Safety Moment may be presented by the leader of an activity, the symposium safety officer, or a member of the host symposium planning team. We ask that all participants give their undivided attention to the Safety Moment discussion and embrace the safety-first concept.

If an injury does occur during the symposium, it should be reported to the competition head judge, symposium safety officer, or activity leader immediately so that appropriate action can be taken based on the injury. If it is a true emergency, please call 911 first.



Contact information for the symposium safety officer and key host school representatives is listed below. Please keep this list close during the symposium and we encourage you to program the symposium safety officer's phone number into your cell phone.

Friday, April 11th, Safety Officer

Andrew Sen – Andrew.sen@marquette.edu - 919-810-2952

Saturday April 12th, Safety Officer

Trevor Schmitt - Schmittt@msoe.edu – 414-277-2326

As a best practice, we strongly recommend that faculty advisors keep and maintain on-hand a list of emergency contact information for their university and participating students. ASCE and the student symposium host do not collect emergency contact

In the spirit of a Safety Moment, here are some safe driving habits to keep in mind as you travel to the student symposium:

- Driving at the speed limit has proven to save lives.
- Do not drive when tired. Swap drivers often.
- Minimum of two people awake at all times when wheels are rolling.
- Be aware of how larger/heavier vehicles behave when stopping or turning.
- Be aware of your surroundings when backing any vehicle, especially trailers. Better yet, avoid backing up at all, if possible.
- Use a spotter to watch when you must back up a vehicle.
- Slow down when the conditions warrant (rain, snow, darkness, pedestrians nearby).
- Perform a circle of safety around your vehicle to identify what is in your blind spots.

Competition Safety Information

Please see the competition rules for full details. If there is a discrepancy between the rules and the information listed below, the competition rules are to be followed.

ASCE Concrete Canoe Competition: Safety gear (closed-toe water shoes and Personal Floatation Device (life jacket)) for each paddler is the responsibility of each team. ([Exhibit 9: Race Regulations & Safety](#)) We also highly encourage the use of waders while flotation testing the canoe.



AISC ASCE Student Steel Bridge Competition: Personal protective equipment is the responsibility of each team. During all construction activities, builders must wear hard hats and protective eyewear or safety goggles ([Section 10.1.6](#)). During all loading activities, competitors must wear hard hats, protective eyewear or safety goggles, work gloves, and steel toe or composite work boots that extend above the ankle ([Section 11.2.1.3](#)). The hardhats must meet ANSI standard Z89.1, and the protective eyewear or safety goggles must meet ANSI standard Z87.1

Surveying Competition: Team members are responsible for providing their own required safety equipment including closed-toe shoes and safety-colored shirts or vests to participate in the field tasks. ([Section 6: Safety](#))

CECSC T-shirt Collection Request

The 2025 ASCE Civil Engineering Student Championships (CECSC) are happening at California Polytechnic State University, San Luis Obispo, from June 27th to 29th, 2025. Cal Poly SLO wants to give a shout-out to all the hard work each team puts in to compete at the symposium level and their journey toward the Society-wide finals. For the 2025 ASCE student symposia, over 800 teams are competing in the 7 Society competitions at 22 student symposia!

While you are at the ASCE Western Great Lakes Student Symposium, Cal Poly SLO is asking every ASCE student chapter to **bring an extra club/symposia/project team tee shirt** (or more if you can!) to your student symposium. These shirts will be collected by the host schools and sent to Cal Poly SLO where they will be displayed for all the competing students, ASCE staff, judges, and committee members to check out.

You can drop off your team's shirt(s) at Check-in at the Marquette Union Sports Annex and before the banquet at UWM. Alternatively, you can get in touch directly with Cal Poly SLO's ASCE Civil Engineering Student Championships Host Chair, Nick Mackecknie, at nmackech@calpoly.edu.

The final display will be featured on the ASCE website this summer. Don't forget to follow Cal Poly SLO's Instagram page @cesc2025 to keep up with the journey to the 2025 ASCE Civil Engineering Student Championships!

Thank you to our sponsors!



**STRUCTURAL
ENGINEERS**



**AMBROSE
ENGINEERING**



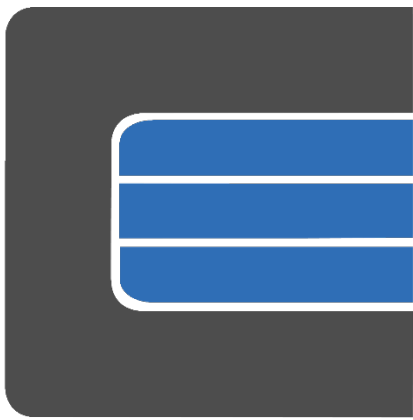

CECO



Jacobs



SMITHGROUP